



181 US Hwy 46  
Mine Hill, NJ 07803  
(908) 654-8068  
(800) 783-0567  
Fax 908-654-8069

## LEAD IN DRINKING WATER REPORT

**Performed At:**

Voorhees High School North Hunterdon High School

**Performed For:**

North Hunterdon-Vorhees Regional High School District

Rob Sabo

1445 State Route 31 South, Annandale, NJ, 08801

**Prepared By:**

LEW Environmental Services, LLC.

181 US Hwy 46

Mine Hill, NJ 07803

Phone (908) 654-8068

Fax (908) 654-8069

Website <http://www.LEWCorp.com>

Inspection Date: 04/24/2025

Project Number: 1977

## Table of Contents

|                                  |   |
|----------------------------------|---|
| Contact Information .....        | 3 |
| Introduction .....               | 4 |
| Sampling Methodology .....       | 4 |
| Drinking Water Results .....     | 5 |
| Recommendations .....            | 5 |
| Additional Recommendations ..... | 6 |

## **Appendices**

|            |                             |
|------------|-----------------------------|
| Appendix A | Exceedances                 |
| Appendix B | Recommendations             |
| Appendix C | All results                 |
| Appendix D | Floor Plan(S)               |
| Appendix E | Water Outlet Inventory(ies) |
| Appendix F | Laboratory Data             |

# Contact Information

## Education Agency

|                 |   |
|-----------------|---|
| Client Contact: | Rob Sabo  |
| Client Name:    | North Hunterdon-Vorhees Regional High School District |
| Street Address: | 1445 State Route 31 South, Annandale, NJ, 08801       |
| Phone Number:   | 908-638-2152  |

## Sampler(s)

|                   |   |
|-------------------|---|
| Site Assessor(s): | Cynthia DiMeo   |
| Signature:        |  |
| Date:             | April 24, 2025  |

## Firm

|                    |   |
|--------------------|---|
| Organization:      | LEW Environmental Services, LLC.                            |
| Certification #:   | NJDCA 00015 E   |
| Street:            | 181 US Hwy 46   |
| City, State & Zip: | Mine Hill, NJ 07803   |
| Phone Number:      | 908-654-8068  |
| Web Address:       | <a href="http://www.lewcorp.com">http://www.lewcorp.com</a> |

## Laboratory

|                       |                                    |
|-----------------------|------------------------------------|
| Organization:         | Environmental Hazard Services, LLC |
| Street:               | 7469 Whitepine Road                |
| City, State & Zip:    | Richmond, VA 23237                 |
| NJDEP Certification # | VA008                              |
| Phone Number:         | 800-347-4010                       |

## **Introduction**

LEW Environmental Services, LLC. was contracted by North Hunterdon-Vorhees Regional High School District to test for the presence of lead in drinking water in two facilities in the district.

## **Sampling Methodology**

LEW Environmental Services, LLC. followed NJAC 6A:26. Full details on sampling practices can be found in Districts Sampling Plan.

All samples were collected in 250mL wide mouth plastic containers that was prepackaged by the analytical laboratory. The sample containers may contain nitric acid, if expedited analysis is required. If not, nitric acid will be added to each sample upon arrival at the laboratory. At each sample location, the first draw sample was taken after it was determined that the water had been standing in the plumbing system for greater than eight hours but less than forty-eight hours. If second draw samples were collected, they were collecting following a flushing protocol outlined in the District's Sampling Plan.

# Drinking Water Results

On April 24, 2025, LEW Environmental Services, LLC. collected the following number of water samples:

## Vorhees High School

- 44 first draw samples collected plus 1 QAQC blank sample
- 4 samples above the 15ppb action level

## North Hunterdon Highschool

- 60 first draw samples collected plus 1 QAQC blank sample
- 2 samples above the 15ppb action level

The complete list of samples that exceeded the 15ppb limit can be found in Appendix A. The complete list of all sample results can be found in Appendix C. The laboratory results can be found in Appendix F.

Certain outlets could not or were not tested due to various reasons. The following table lists those locations and the reason why samples were not collected.

| School                      | Sample Location     | Reason for not testing. |
|-----------------------------|---------------------|-------------------------|
| Voorhess High School        | WC - Weightroom     | Not functional          |
| North Hunterdon High School | WC-Cafeteria B      | Not functional          |
| North Hunterdon High School | WF-Principal office | Not functional          |
| North Hunterdon High School | S-Rm 125            | Handwash only           |
| North Hunterdon High School | WF-Rm 126           | Not functional          |
| North Hunterdon High School | IM-Nurse Office     | Not functional          |

## Recommendations

Use following language for first draw sampling only

On April 24, 2025, LEW Environmental Services, LLC. collected the first draw samples. We recommend the following actions.

Those outlets where the first draw sample tested below 15ppb are not considered to be elevated and no remediation is necessary.

For those outlets where the first draw sample exceeds 15ppb the following steps are recommended:

- 1) Immediately discontinue use of the outlets.
- 2) Conduct second draw (flush) samples on these outlets to further delineate source of contamination.

## Additional Recommendations

- 1) Follow-up samples should be collected after any remediation efforts in order to determine the efficacy of the work.
- 2) Any of the inoperable/non-functioning outlets listed above that are brought back into service should be sampled.
- 3) Comply with all requirements set forth in NJAC 6A:26.

## **Appendix A    Exceedances**

| Building | DateCollected | AnalysisDate | Sample ID   | Sample Description | Concentration (ppb) |
|----------|---------------|--------------|-------------|--------------------|---------------------|
| NHRHS    | 4/24/2025     | 5/8/2025     | 41-NHRHS-S  | SNACK BAR          | 815                 |
| NHRHS    | 4/24/2025     | 5/7/2025     | 44-NHRHS-BB | HALL G             | 25.3                |
| VHS      | 4/24/2025     | 5/7/2025     | 1A-VHS-WC   | OUTSIDE RM 165     | 22.9                |
| VHS      | 4/24/2025     | 5/7/2025     | 3-VHS-S     | NURSE              | 17                  |
| VHS      | 4/24/2025     | 5/7/2025     | 12-VHS-S    | KITCHEN            | 16.2                |
| VHS      | 4/24/2025     | 5/7/2025     | 38-VHS-S    | SCIENCE OFFICE     | 30.6                |

## **Appendix B    Recommendations**

| Building | Location       | Remediation Recommendation                       |
|----------|----------------|--|
| NHRHS    | SNACK BAR      | Discontinue use and perform second draw sampling |
| NHRHS    | HALL G         | Discontinue use and perform second draw sampling |
| VHS      | OUTSIDE RM 165 | Discontinue use and perform second draw sampling |
| VHS      | NURSE          | Discontinue use and perform second draw sampling |
| VHS      | KITCHEN        | Discontinue use and perform second draw sampling |
| VHS      | SCIENCE OFFICE | Discontinue use and perform second draw sampling |

## **Appendix C    All Results**

| Building | DateCollected | AnalysisDate | Sample ID    | Sample Description | Concentration (ppb) |
|----------|---------------|--------------|--------------|--------------------|---------------------|
| NHRHS    | 4/24/2025     | 5/8/2025     | 1-NHRHS-S    | KITCHEN            | 1.89                |
| NHRHS    | 4/24/2025     | 5/7/2025     | 2-NHRHS-S    | KITCHEN            | 1.64                |
| NHRHS    | 4/24/2025     | 5/7/2025     | 3-NHRHS-S    | KITCHEN            | 1.48                |
| NHRHS    | 4/24/2025     | 5/7/2025     | 4-NHRHS-S    | KITCHEN            | 2.4                 |
| NHRHS    | 4/24/2025     | 5/7/2025     | 5-NHRHS-WC   | FACULTY DINING     | 2.56                |
| NHRHS    | 4/24/2025     | 5/7/2025     | 6-NHRHS-WC   | CAFE A LEFT        | 2.2                 |
| NHRHS    | 4/24/2025     | 5/7/2025     | 7-NHRHS-WC   | CAFE A RIGHT       | 12.3                |
| NHRHS    | 4/24/2025     | 5/7/2025     | 8-NHRHS-WC   | CAFE B LEFT        | 2.31                |
| NHRHS    | 4/24/2025     | 5/7/2025     | 10-NHRHS-IM  | KITCHEN            | <1.00               |
| NHRHS    | 4/24/2025     | 5/7/2025     | 11-NHRHS-WC  | HALL A LEFT        | <1.00               |
| NHRHS    | 4/24/2025     | 5/7/2025     | 11A-NHRHS-WC | HALL A RIGHT WC    | <1.00               |
| NHRHS    | 4/24/2025     | 5/7/2025     | 11B-NHRHS-BF | HALL A RIGHT BF    | <1.00               |
| NHRHS    | 4/24/2025     | 5/7/2025     | 14A-NHRHS-WC | OUTSIDE CAFE A     | <1.00               |
| NHRHS    | 4/24/2025     | 5/7/2025     | 14B-NHRHS-BF | OUTSIDE CAFE A     | <1.00               |
| NHRHS    | 4/24/2025     | 5/8/2025     | 15-NHRHS-S1  | ROOM 229           | 1.6                 |
| NHRHS    | 4/24/2025     | 5/7/2025     | 15A-NHRHS-S2 | ROOM 229           | 1.34                |
| NHRHS    | 4/24/2025     | 5/8/2025     | 15B-NHRHS-S3 | ROOM 229           | 2.71                |
| NHRHS    | 4/24/2025     | 5/8/2025     | 16-NHRHS-S4  | ROOM 229           | 4.13                |
| NHRHS    | 4/24/2025     | 5/8/2025     | 16A-NHRHS-S5 | ROOM 229           | 2.65                |
| NHRHS    | 4/24/2025     | 5/7/2025     | 16B-NHRHS-S6 | ROOM 229           | 1.47                |
| NHRHS    | 4/24/2025     | 5/7/2025     | 17-NHRHS-WC  | HALL A-2           | <1.00               |
| NHRHS    | 4/24/2025     | 5/7/2025     | 18-NHRHS-WC  | HALL A-2           | <1.00               |
| NHRHS    | 4/24/2025     | 5/7/2025     | 18A-NHRHS-BF | HALL A-2           | <1.00               |
| NHRHS    | 4/24/2025     | 5/7/2025     | 19-NHRHS-BB  | OUTSIDE RM 223     | 4.55                |
| NHRHS    | 4/24/2025     | 5/7/2025     | 19B-NHRHS-BB | OUTSIDE RM 223     | 5.41                |
| NHRHS    | 4/24/2025     | 5/7/2025     | 20-NHRHS-WC  | HALL C             | 5.63                |
| NHRHS    | 4/24/2025     | 5/7/2025     | 21-NHRHS-WC  | HALL C2            | 7.31                |
| NHRHS    | 4/24/2025     | 5/7/2025     | 22-NHRHS-BB  | HALL A2 LEFT       | 1.83                |
| NHRHS    | 4/24/2025     | 5/7/2025     | 23-NHRHS-BB  | HALL A2 RIGHT      | 2.03                |
| NHRHS    | 4/24/2025     | 5/7/2025     | 24-NHRHS-S   | RM 121             | 3.1                 |
| NHRHS    | 4/24/2025     | 5/7/2025     | 25-NHRHS-WC  | RM 121             | 1.58                |
| NHRHS    | 4/24/2025     | 5/7/2025     | 28-NHRHS-WC  | RM 128             | <1.00               |
| NHRHS    | 4/24/2025     | 5/7/2025     | 29-NHRHS-WC  | WEIGHT ROOM        | <1.00               |
| NHRHS    | 4/24/2025     | 5/7/2025     | 29A-NHRHS-IM | RM 026             | <1.00               |
| NHRHS    | 4/24/2025     | 5/7/2025     | 30-NHRHS-WC  | RM 026             | <1.00               |
| NHRHS    | 4/24/2025     | 5/8/2025     | 30A-NHRHS-WC | RM 026             | <1.00               |
| NHRHS    | 4/24/2025     | 5/7/2025     | 30B-NHRHS-BF | RM 026             | <1.00               |
| NHRHS    | 4/24/2025     | 5/7/2025     | 31-NHRHS-BB  | RM 130             | 4.7                 |
| NHRHS    | 4/24/2025     | 5/7/2025     | 31A-NHRHS-S  | RM 130             | 1.32                |
| NHRHS    | 4/24/2025     | 5/7/2025     | 32-NHRHS-S   | NURSE OFFICE       | 7.12                |
| NHRHS    | 4/24/2025     | 5/8/2025     | 33-NHRHS-S   | NURSE OFFICE       | 1.75                |
| NHRHS    | 4/24/2025     | 5/7/2025     | 36-NHRHS-WC  | HALL D             | <1.00               |
| NHRHS    | 4/24/2025     | 5/7/2025     | 36A-NHRHS-WC | HALL D             | <1.00               |
| NHRHS    | 4/24/2025     | 5/7/2025     | 36B-NHRHS-BF | HALL D             | <1.00               |
| NHRHS    | 4/24/2025     | 5/7/2025     | 37-NHRHS-S   | TRAINERS RM        | 3.58                |
| NHRHS    | 4/24/2025     | 5/7/2025     | 38-NHRHS-IM  | TRAINERS RM        | <1.00               |
| NHRHS    | 4/24/2025     | 5/7/2025     | 39-NHRHS-WC  | HALL E LEFT        | <1.00               |
| NHRHS    | 4/24/2025     | 5/7/2025     | 39A-NHRHS-WC | HALL E LEFT        | <1.00               |
| NHRHS    | 4/24/2025     | 5/7/2025     | 40-NHRHS-WC  | HALL E RIGHT       | <1.00               |
| NHRHS    | 4/24/2025     | 5/7/2025     | 40A-NHRHS-WC | HALL E RIGHT       | <1.00               |
| NHRHS    | 4/24/2025     | 5/8/2025     | 41-NHRHS-S   | SNACK BAR          | 815                 |
| NHRHS    | 4/24/2025     | 5/7/2025     | 42-NHRHS-BB  | HALL F             | 4.7                 |
| NHRHS    | 4/24/2025     | 5/7/2025     | 44-NHRHS-BB  | HALL G             | 25.3                |
| NHRHS    | 4/24/2025     | 5/7/2025     | 45-NHRHS-S   | GUIDANCE           | 5.51                |
| NHRHS    | 4/24/2025     | 5/7/2025     | 46-NHRHS-WC  | HALL G 2           | <1.00               |
| NHRHS    | 4/24/2025     | 5/7/2025     | 46A-NHRHS-BF | HALL G 2           | <1.00               |
| NHRHS    | 4/24/2025     | 5/7/2025     | 47-NHRHS-WC  | ROOM 203           | <1.00               |
| NHRHS    | 4/24/2025     | 5/7/2025     | 47A-NHRHS-BF | ROOM 203           | <1.00               |
| NHRHS    | 4/24/2025     | 5/7/2025     | 48-NHRHS-WC  | HALL H             | <1.00               |
| NHRHS    | 4/24/2025     | 5/7/2025     | 49-NHRHS-BF  | HALL H             | <1.00               |
| NHRHS    | 4/24/2025     | 5/7/2025     | 50-NHRHS-S   | CONTROL SAMPLE     | <1.00               |

| Building | DateCollected | AnalysisDate | Sample ID  | Sample Description  | Concentration (ppb) |
|----------|---------------|--------------|------------|---------------------|---------------------|
| VHS      | 4/24/2025     | 5/7/2025     | 1-VHS-S    | ROOM 165            | 4.12                |
| VHS      | 4/24/2025     | 5/7/2025     | 1A-VHS-WC  | OUTSIDE RM 165      | 22.9                |
| VHS      | 4/24/2025     | 5/7/2025     | 2-VHS-S    | ROOM 163            | 6.68                |
| VHS      | 4/24/2025     | 5/7/2025     | 2A-VHS-WC  | ACROSS FROM THEATER | <1.00               |
| VHS      | 4/24/2025     | 5/7/2025     | 2B-VHS-BF  | ACROSS FROM THEATER | <1.00               |
| VHS      | 4/24/2025     | 5/7/2025     | 3-VHS-S    | NURSE               | 17                  |
| VHS      | 4/24/2025     | 5/7/2025     | 4-VHS-WC   | NURSE               | 1.14                |
| VHS      | 4/24/2025     | 5/7/2025     | 6-VHS-S    | GUIDANCE RM 132     | 3.75                |
| VHS      | 4/24/2025     | 5/7/2025     | 7-VHS-WC   | CAFE 2 HALL         | <1.00               |
| VHS      | 4/24/2025     | 5/7/2025     | 7A-VHS-BF  | CAFE 2 HALL         | <1.00               |
| VHS      | 4/24/2025     | 5/7/2025     | 8-VHS-WC   | CAFE 1 HALL         | <1.00               |
| VHS      | 4/24/2025     | 5/7/2025     | 8A-VHS-BF  | CAFE 1 HALL         | <1.00               |
| VHS      | 4/24/2025     | 5/7/2025     | 9-VHS-S    | KITCHEN             | 3.28                |
| VHS      | 4/24/2025     | 5/7/2025     | 10-VHS-S   | KITCHEN             | 1.87                |
| VHS      | 4/24/2025     | 5/7/2025     | 11-VHS-S   | KITCHEN             | 2.36                |
| VHS      | 4/24/2025     | 5/7/2025     | 12-VHS-S   | KITCHEN             | 16.2                |
| VHS      | 4/24/2025     | 5/7/2025     | 13-VHS-IM  | KITCHEN             | <1.00               |
| VHS      | 4/24/2025     | 5/7/2025     | 16-VHS-BB  | WRESTLING ROOM      | 6.23                |
| VHS      | 4/24/2025     | 5/7/2025     | 17-VHS-IM  | TRAINER ROOM        | 4.15                |
| VHS      | 4/24/2025     | 5/7/2025     | 18-VHS-WC  | GIRLS LOCKER ROOM   | 9.79                |
| VHS      | 4/24/2025     | 5/7/2025     | 19-VHS-WC  | MAINTENANCE         | 1.82                |
| VHS      | 4/24/2025     | 5/7/2025     | 20-VHS-WC  | UPPER GYM LOBBY     | <1.00               |
| VHS      | 4/24/2025     | 5/7/2025     | 20A-VHS-BF | UPPER GYM LOBBY     | <1.00               |
| VHS      | 4/24/2025     | 5/7/2025     | 23-VHS-WC  | ROOM 250            | 2.01                |
| VHS      | 4/24/2025     | 5/7/2025     | 24-VHS-WC  | ROOM 244            | <1.00               |
| VHS      | 4/24/2025     | 5/7/2025     | 24A-VHS-BF | ROOM 244            | <1.00               |
| VHS      | 4/24/2025     | 5/7/2025     | 25-VHS-S   | ROOM 244            | 6.64                |
| VHS      | 4/24/2025     | 5/7/2025     | 28-VHS-S   | LIBRARY OFFICE      | 4.49                |
| VHS      | 4/24/2025     | 5/7/2025     | 29-VHS-S   | RM 261              | 7.02                |
| VHS      | 4/24/2025     | 5/7/2025     | 30-VHS-WC  | 259 HALL            | <1.00               |
| VHS      | 4/24/2025     | 5/7/2025     | 30A-VHS-BF | 259 HALL            | <1.00               |
| VHS      | 4/24/2025     | 5/7/2025     | 31-VHS-WC  | 215 HALL            | <1.00               |
| VHS      | 4/24/2025     | 5/7/2025     | 31A-VHS-BF | 215 HALL            | <1.00               |
| VHS      | 4/24/2025     | 5/7/2025     | 33-VHS-S1  | ROOM 210            | 2.17                |
| VHS      | 4/24/2025     | 5/7/2025     | 33A-VHS-S2 | ROOM 210            | 1.76                |
| VHS      | 4/24/2025     | 5/7/2025     | 34-VHS-S3  | ROOM 210            | 3.12                |
| VHS      | 4/24/2025     | 5/7/2025     | 34A-VHS-S4 | ROOM 210            | 5.16                |
| VHS      | 4/24/2025     | 5/7/2025     | 34B-VHS-S5 | ROOM 210            | 7.81                |
| VHS      | 4/24/2025     | 5/7/2025     | 35-VHS-S   | ROOM 212            | 6.52                |
| VHS      | 4/24/2025     | 5/7/2025     | 38-VHS-S   | SCIENCE OFFICE      | 30.6                |
| VHS      | 4/24/2025     | 5/7/2025     | 39-VHS-WC  | 318 HALL            | 1.93                |
| VHS      | 4/24/2025     | 5/7/2025     | 40-VHS-WC  | 324 HALL            | <1.00               |
| VHS      | 4/24/2025     | 5/7/2025     | 40A-VHS-BF | 324 HALL            | <1.00               |
| VHS      | 4/24/2025     | 5/7/2025     | 41-VHS-IM  | 246 CUSTODIAN       | <1.00               |
| VHS      | 4/24/2025     | 5/7/2025     | 42-VHS-S   | CONTROL SAMPLE      | <1.00               |

**Appendix D      Floor Plan(s)**



N Hunterdon HS/Voorhees HS Sampling Plan  
 2/15/17  
 Version 1

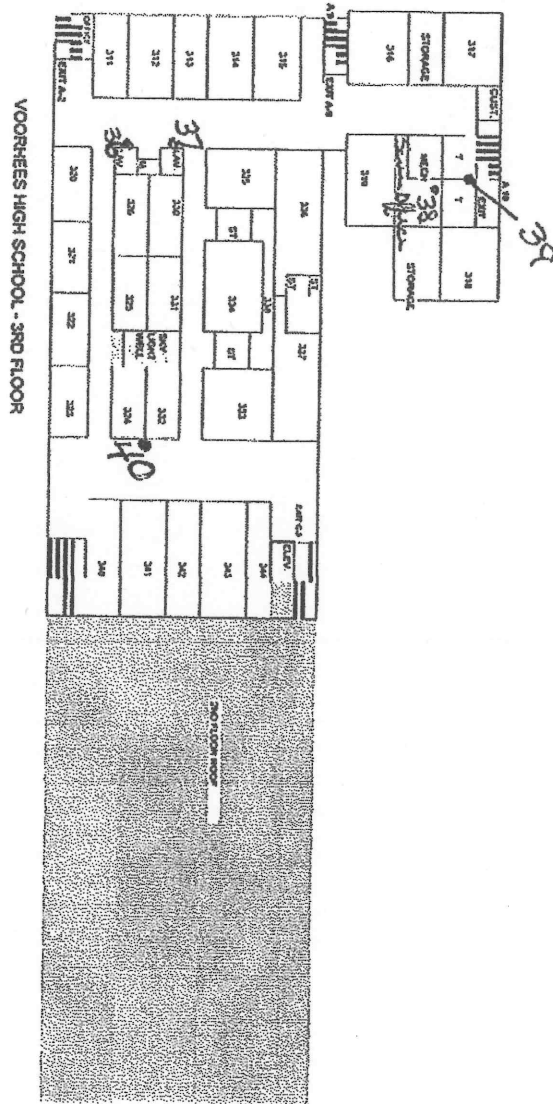

N Hunterdon HS/Voorhees HS Sampling Plan  
 2/15/17  
 Version 1

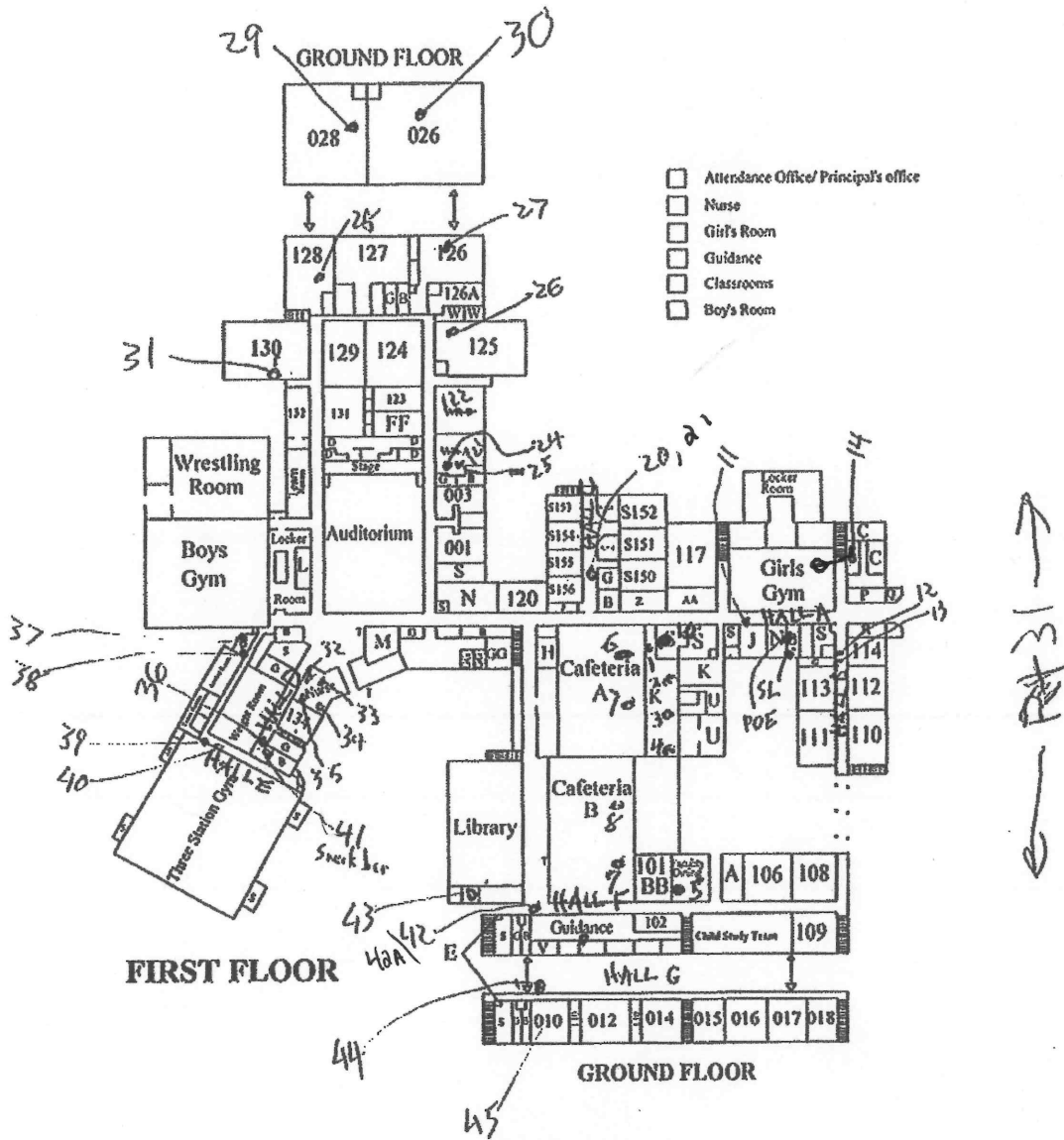

North Hunterdon High School

N Hunterdon HS/Voorhees HS Sampling Plan  
 2/15/17  
 Version 1

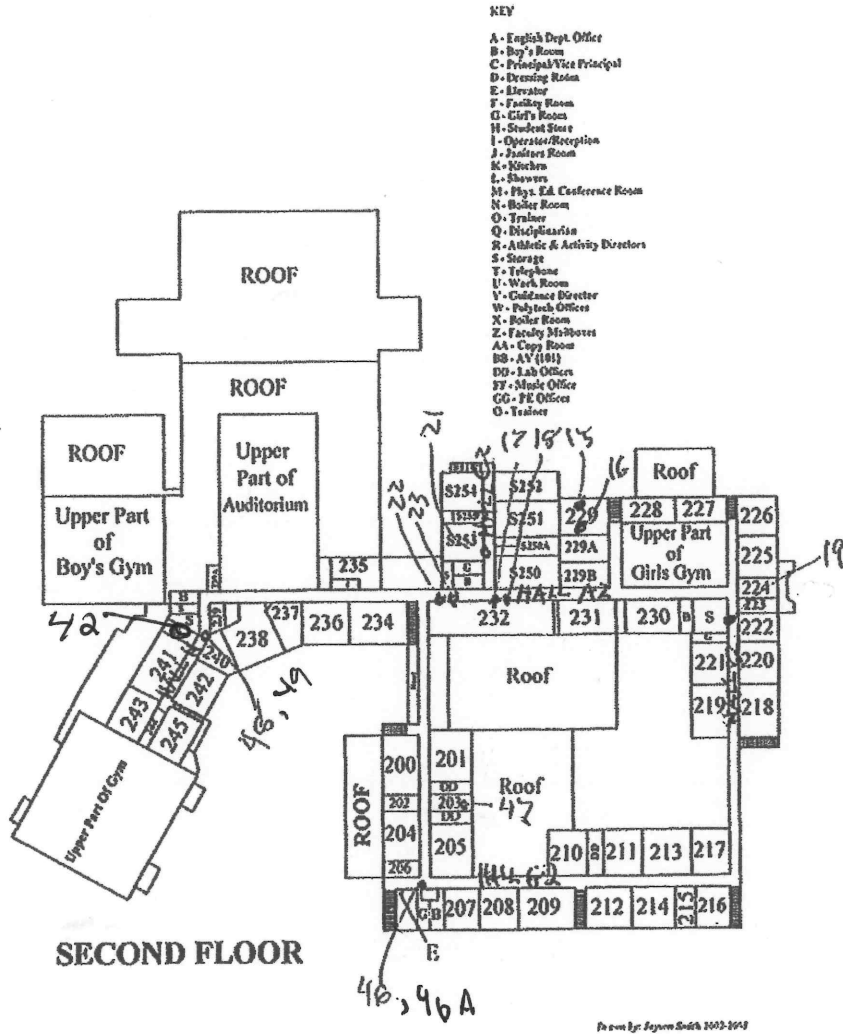

North Hunterdon High School

## **Appendix E      Water Outlet Inventory(ies)**



|      |               |                  |          |   |   |   |   |   |   |   |       |                |                 |
|------|---------------|------------------|----------|---|---|---|---|---|---|---|-------|----------------|-----------------|
| 12   | bubbler       | Hall B           | NHRHS-DW | y | n | n | y | n | n | n |       |                |                 |
| 13   | bubbler       | Hall B           | NHRHS-DW | y | n | n | y | n | n | n |       |                |                 |
| 14   | fountain      | Principal offive | NHRHS-DW | y | n | n | y | y | n | n |       |                | Not Functioning |
| 14A  | water cooler  | outside café A   | NHRHS-WC | y | n | n | y | y | n | n |       |                |                 |
| 14 B | bottle filler | outside café A   | NHRHS-BF | y | n | n | y | y | n | n |       |                |                 |
| 15   | sink 1        | Rm 229           | NHRHS-EC | y | n | n | y | n | n | n |       |                |                 |
| 15 A | sink 2        | Rm 229           | NHRHS-S  | y | n | n | y | n | n | n |       |                |                 |
| 15 B | sink 3        | Rm 229           | NHRHS-S  | y | n | n | y | n | n | n |       |                |                 |
| 16   | sink 4        | Rm 229           | NHRHS-EC | y | n | n | y | n | n | n |       |                |                 |
| 16 A | sink 5        | Rm 229           | NHRHS-S  | y | n | n | y | n | n | n |       |                |                 |
| 16 B | sink 6        | Rm 229           | NHRHS-S  | y | n | n | y | n | n | n |       |                |                 |
| 17   | water cooler  | Hall A2          | NHRHS-DW | y | n | n | y | n | n | n |       |                |                 |
| 18   | water cooler  | Hall A2          | NHRHS-DW | y | n | n | y | n | n | n |       |                |                 |
| 18 A | bottle filler | Hall A2          | NHRHS-BF | y | n | n | y | n | n | n |       |                |                 |
| 19   | bubbler       | Hall Rm 223      | NHRHS-DW | y | n | n | y | n | n | n |       |                |                 |
| 19 B | bubbler       | Hall Rm 223      | NHRHS-BB | y | n | n | y | n | n | n |       |                |                 |
| 20   | water cooler  | Hall C           | NHRHS-WC | y | n | n | y | n | n | y | Elkay | ERPA28RAC<br>N |                 |
| 21   | water cooler  | Hall C2          | NHRHS-WC | y | n | n | y | n | n | y | Elkay | ERPA28RAC<br>N |                 |
| 22   | bubbler       | Hall A2-Left     | NHRHS-DW | y | n | n | y | n | n | n |       |                |                 |

|      |               |               |          |   |   |   |   |   |   |   |               |            |                 |
|------|---------------|---------------|----------|---|---|---|---|---|---|---|---------------|------------|-----------------|
| 23   | bubbler       | Hall A2-Right | NHRHS-DW | y | n | n | y | n | n | n |               |            |                 |
| 24   | sink          | Rm 121        | NHRHS-EC | y | n | n | y | n | n | n |               |            |                 |
| 25   | water cooler  | Rm 121        | NHRHS-WC | y | n | n | y | n | n | y | Elkay         | none       |                 |
| 26   | sink          | Rm 125        | NHRHS-DW | y | n | n | y | n | n | n |               |            | Hand Wash Only  |
| 27   | bubbler       | Rm 126        | NHRHS-DW | y | n | n | y | n | n | n |               |            | Not Functioning |
| 28   | bubbler       | Rm 128        | NHRHS-DW | y | n | n | y | n | n | n |               |            |                 |
| 29   | water cooler  | Weight Rm     | NHRHS-WC | y | n | n | y | n | n | y | Halsey Taylor | S1000-10EG |                 |
| 29 A | Ice Machine   | Rm 026        | NHRHS-IM | y | n | n | y | n | n | y |               |            |                 |
| 30   | water cooler  | Rm 026        | NHRHS-DW | y | n | n | y | n | n | n |               |            |                 |
| 30 A | water cooler  | Rm 026        | NHRHS-WC | y | n | n | y | n | n | n |               |            |                 |
| 30 B | bottle filler | Rm 026        | NHRHS-BF | y | n | n | y | n | n | n |               |            |                 |
| 31   | bubbler       | Rm 130        | NHRHS-DW | y | n | n | y | n | n | n |               |            |                 |
| 31A  | sink          | Rm 130        | NHRHS-S  | y | n | n | y | n | n | n |               |            |                 |
| 32   | sink          | Nurse office  | NHRHS-NS | y | n | n | y | y | y | n |               |            |                 |
| 33   | sink          | Nurse office  | NHRHS-NS | y | n | n | y | y | n | n |               |            |                 |
| 34   | sink          | Nurse office  | NHRHS-NS | y | n | n | y | y | y | n |               |            |                 |
| 35   | Ice Machine   | Nurse office  | NHRHS-IM | y | n | n | y | n | n | y | Manitowoc     | none       | Not Functioning |
| 36   | water cooler  | Hall D        | NHRHS-WC | y | n | n | y | n | n | y | Elkay         | LZWSR-C    |                 |
| 36A  | water cooler  | Hall D        | NHRHS-WC | y | n | n | y | n | n | y |               |            |                 |



|  |  |  |  |  |  |  |  |  |  |  |  |  |  |
|--|--|--|--|--|--|--|--|--|--|--|--|--|--|
|  |  |  |  |  |  |  |  |  |  |  |  |  |  |
|  |  |  |  |  |  |  |  |  |  |  |  |  |  |
|  |  |  |  |  |  |  |  |  |  |  |  |  |  |
|  |  |  |  |  |  |  |  |  |  |  |  |  |  |
|  |  |  |  |  |  |  |  |  |  |  |  |  |  |

[1] Number outlets starting at the closest outlet to the Point of Entry (POE).

[2] Document if permanently or temporarily out of service on the Attachment B- Plumbing Profile.

[3] Signs of corrosion detected, such as but not limited to frequent leaks, rust-colored water, or stained fixtures, dishes, or laundry.

[4] Document on Attachment D- Filter Inventory.

## Attachment C - Water Outlet Inventory

(To be completed for each school)

Name of School: Vorhees High School \_\_\_\_\_ Address: 256 County Rt 513 Glen Gardner NJ \_\_\_\_\_

Grade Levels: 9-12 \_\_\_\_\_ Year School Constructed: 1975 \_\_\_\_\_ Renovations/Additions: 1984 \_\_\_\_\_

Individual school project officer Name/Signature: \_ Frank Bigelli \_\_\_\_\_ Date completed: \_12/09/2016 \_\_\_\_\_

| #[1] | Type          | Location               | Code   | Operating<br>[2]<br>(Y/N) | Corrosion<br>[3]<br>(Y/N) | Filter [4]<br>(Y/N) | Brass<br>Fittings,<br>Faucets or<br>valves?<br>(Y/N) | Aerator/<br>Screen<br>(Y/N) | Motion<br>Activated<br>(Y/N) | Chiller<br>(Y/N) | Water Cooler     |          | Comments    |
|------|---------------|------------------------|--------|---------------------------|---------------------------|---------------------|--|-----------------------------|------------------------------|------------------|------------------|----------|-------------|
|      |               |                        |        |                           |                           |                     |  |                             |                              |                  | Make             | Model    |             |
| 1    | sink          | Rm 164                 | VHS-DW | y                         | n                         | n                   | y  | y                           | n                            | n                |                  |          |             |
| 1A   | Water Cooler  | Rm 165                 | VHS-WC | y                         | n                         | n                   | y  | y                           | n                            | n                |                  |          |             |
| 2    | sink          | Rm 163                 | VHS-DW | y                         | n                         | n                   | y  | y                           | n                            | n                |                  |          |             |
| 2A   | Water Cooler  | Across from<br>theater | VHS-WC | y                         | n                         | n                   | y  | y                           | n                            | n                |                  |          |             |
| 2B   | Bottle Filler | Across from<br>theater | VHS-BF | y                         | n                         | n                   | y  | y                           | n                            | n                |                  |          |             |
| 3    | sink          | Nurse                  | VHS-NS | y                         | n                         | n                   | y  | y                           | n                            | n                |                  |          |             |
| 4    | Water Cooler  | Nurse                  | VHS-NS | y                         | n                         | n                   | y  | n                           | n                            | y                | Halsey<br>Taylor | NA       |             |
| 5    | sink          | Nurse                  | VHS-NS | y                         | n                         | n                   | y  | n                           | n                            | n                |                  |          | Non-potable |
| 6    | sink          | Guidance rm 132        | VHS-DW | y                         | n                         | n                   | y  | n                           | n                            | n                |                  |          |             |
| 7    | Water Cooler  | Cafeteria 2 Hall       | VHS-WC | y                         | n                         | n                   | y  | n                           | n                            | y                | Halsey<br>Taylor | NA       |             |
| 7A   | Bottle Filler | Cafeteria 2 Hall       | VHS-BF | y                         | n                         | n                   | y  | n                           | n                            | y                |                  |          |             |
| 8    | Water Cooler  | Cafeteria 1 Hall       | VHS-WC | y                         | n                         | n                   | y  | n                           | n                            | y                | Elkay            | LZWSR-1C |             |

|     |               |                  |        |   |   |   |   |   |   |   |                          |            |                 |
|-----|---------------|------------------|--------|---|---|---|---|---|---|---|--------------------------|------------|-----------------|
| 8A  | Bottle Filler | Cafeteria 1 Hall | VHS-BF | y | n | n | y | n | n | y |                          |            |                 |
| 9   | sink          | Kitchen          | VHS-FP | y | n | n | y | n | n | n |                          |            |                 |
| 10  | sink          | Kitchen          | VHS-FP | y | n | n | y | n | n | n |                          |            |                 |
| 11  | sink          | Kitchen          | VHS-FP | y | n | n | y | n | n | n |                          |            |                 |
| 12  | sink          | Kitchen          | VHS-FP | y | n | n | y | n | n | n |                          |            |                 |
| 13  | ice machine   | kitchen          | VHS-IM | y | n | n | y | n | n | y | Manitowoc                | NA         |                 |
| 14  | water cooler  | Gym lower lobby  | VHS-WC | y | n | n | y | n | n | y | <del>Halsey Taylor</del> | NA         |                 |
| 15  | water cooler  | Weight Rm        | VHS-WC | y | n | n | y | n | n | y | Halsey Taylor            | NA         | Not Functioning |
| 16  | bubbler       | Wrestling        | VHS-DW | y | n | n | y | n | n | n |                          |            |                 |
| 17  | ice machine   | Trainer Rm       | VHS-IM | y | n | n | y | n | n | y | Manitowoc                | IY0454A161 |                 |
| 18  | water cooler  | Girls Locker Rm  | VHS-WC | y | n | n | y | n | n | y | Halsey Taylor            | NA         |                 |
| 19  | water cooler  | Maintenance      | VHS-WC | y | n | n | y | n | n | y | Halsey Taylor            | NA         |                 |
| 20  | water cooler  | Upper Gym Lobby  | VHS-WC | y | n | n | y | n | n | y | Elkay                    | LZWSR-1C   |                 |
| 20A | bottle filler | Upper Gym Lobby  | VHS-BF | y | n | n | y | n | n | y |                          |            |                 |
| 21  | water cooler  | Rm 247           | VHS-WC | y | n | n | y | n | n | y | <del>Halsey Taylor</del> | NA         |                 |
| 22  | bubbler       | Rm 247           | VHS-DW | y | n | n | y | n | n | n |                          |            |                 |
| 23  | water cooler  | Rm 250           | VHS-WC | y | n | n | y | n | n | y | Halsey Taylor            | NA         |                 |
| 24  | water cooler  | Rm 244           | VHS-WC | y | n | n | y | n | n | y | Sunroc                   | NA         |                 |
| 24A | bottle filler | Rm 244           | VHS-BF | y | n | n | y | n | n | y | Sunroc                   | NA         |                 |

|               |                         |                     |                   |              |              |              |              |              |              |              |                          |          |  |
|---------------|-------------------------|---------------------|-------------------|--------------|--------------|--------------|--------------|--------------|--------------|--------------|--------------------------|----------|--|
| 25            | sink                    | Rm 244              | VHS-DW            | y            | n            | n            | y            | n            | n            | n            |                          |          |  |
| <del>26</del> | <del>water cooler</del> | <del>Art Hall</del> | <del>VHS-WC</del> | <del>y</del> | <del>n</del> | <del>n</del> | <del>y</del> | <del>n</del> | <del>n</del> | <del>y</del> | <del>Halsey Taylor</del> | NA       |  |
| 28            | sink                    | Library Office      | VHS-DW            | y            | n            | n            | y            | n            | n            | n            |                          |          |  |
| 29            | sink                    | Rm 261              | VHS-DW            | y            | n            | n            | y            | n            | n            | n            |                          |          |  |
| 30            | water cooler            | 259 Hall            | VHS-WC            | y            | n            | n            | y            | n            | n            | y            | unknown                  |          |  |
| 30A           | bottle filler           | 259 Hall            | VHS-BF            | y            | n            | n            | y            | n            | n            | y            |                          |          |  |
| 31            | water cooler            | 215 Hall            | VHS-DW            | y            | n            | n            | y            | n            | n            | n            |                          |          |  |
| 31A           | bottle filler           | 215 Hall            | VHS-BF            | y            | n            | n            | y            | n            | n            | n            |                          |          |  |
| <del>32</del> | <del>bubbler</del>      | <del>216 Hall</del> | <del>VHS-DW</del> | <del>y</del> | <del>n</del> | <del>n</del> | <del>y</del> | <del>n</del> | <del>n</del> | <del>n</del> |                          |          |  |
| 33            | sink 1                  | Rm 210              | VHS-EC            | y            | n            | n            | y            | y            | n            | n            |                          |          |  |
| 33A           | sink 2                  | Rm 210              | VHS-S             | y            | n            | n            | y            | y            | n            | n            |                          |          |  |
| 34            | sink 3                  | Rm 210              | VHS-EC            | y            | n            | n            | y            | y            | n            | n            |                          |          |  |
| 34A           | sink 4                  | Rm 210              | VHS-S             | y            | n            | n            | y            | y            | n            | n            |                          |          |  |
| 34B           | sink 5                  | Rm 210              | VHS-S             | y            | n            | n            | y            | y            | n            | n            |                          |          |  |
| 35            | sink                    | Rm 212              | VHS-DW            | y            | n            | n            | y            | y            | n            | n            |                          |          |  |
| <del>36</del> | <del>bubbler</del>      | <del>311 Hall</del> | <del>VHS-DW</del> | <del>y</del> | <del>n</del> | <del>n</del> | <del>y</del> | <del>n</del> | <del>n</del> | <del>n</del> |                          |          |  |
| <del>37</del> | <del>bubbler</del>      | <del>311 Hall</del> | <del>VHS-DW</del> | <del>y</del> | <del>n</del> | <del>n</del> | <del>y</del> | <del>n</del> | <del>n</del> | <del>n</del> |                          |          |  |
| 38            | sink                    | Science office      | VHS-DW            | y            | n            | n            | y            | y            | n            | n            |                          |          |  |
| 39            | water cooler            | 318 Hall            | VHS-WC            | y            | n            | n            | y            | n            | n            | y            | Oasis                    | PLFCM001 |  |
| 40            | water cooler            | 324 Hall            | VHS-WC            | y            | n            | n            | y            | n            | n            | y            | Halsey Taylor            |          |  |

|     |               |               |        |   |   |   |   |   |   |   |           |    |  |
|-----|---------------|---------------|--------|---|---|---|---|---|---|---|-----------|----|--|
| 40A | bottle filler | 324 Hall      | VHS-BF | y | n | n | y | n | n | y |           |    |  |
| 41  | Ice Machine   | 246 Custodian | VHS-IM | y | n | n | y | n | n | y | Manitowoc | NA |  |

[1] Number outlets starting at the closest outlet to the Point of Entry (POE).

[2] Document if permanently or temporarily out of service on the Attachment B- Plumbing Profile.

[3] Signs of corrosion detected, such as but not limited to frequent leaks, rust-colored water, or stained fixtures, dishes, or laundry.

[4] Document on Attachment D- Filter Inventory.

## **Appendix F      Laboratory Data**



7469 Whitepine Rd  
 North Chesterfield, VA 23237  
 Telephone: 800.347.4010

## Lead in Drinking Water Analysis Report

Report Number: 25-04-05467

Client: LEW Corp  
 181 US Hwy 46  
 Mine Hill, NJ 07803

Received Date: 04/30/2025  
 Reported Date: 05/08/2025  
 Sampled By: Cindy DiMeo  
 Tech Certification #:

Project/Test Address: 1977; VHS; 256 County Rd 513; Glen Gardner, NJ 08826

Client Number:  
 201327

# Laboratory Results

Fax Number:  
 Ext 18 Melissa

| Lab Sample Number | Client Sample ID | Collection Date | Collection Location | Concentration ug/L (ppb) | Analysis Date | Narrative ID |
|-------------------|------------------|-----------------|---------------------|--------------------------|---------------|--------------|
| 25-04-05467-001   | 1-VHS-S          | 04/24/2025      | ROOM 165            | 4.12                     | 05/07/2025    |              |
| 25-04-05467-002   | 1A-VHS-WC        | 04/24/2025      | OUTSIDE RM 165      | 22.9                     | 05/07/2025    |              |
| 25-04-05467-003   | 2-VHS-S          | 04/24/2025      | ROOM 163            | 6.68                     | 05/07/2025    |              |
| 25-04-05467-004   | 2A-VHS-WC        | 04/24/2025      | ACROSS FROM THEATER | <1.00                    | 05/07/2025    |              |
| 25-04-05467-005   | 2B-VHS-BF        | 04/24/2025      | ACROSS FROM THEATER | <1.00                    | 05/07/2025    |              |
| 25-04-05467-006   | 3-VHS-S          | 04/24/2025      | NURSE               | 17.0                     | 05/07/2025    |              |
| 25-04-05467-007   | 4-VHS-WC         | 04/24/2025      | NURSE               | 1.14                     | 05/07/2025    |              |
| 25-04-05467-008   | 6-VHS-S          | 04/24/2025      | GUIDANCE RM 132     | 3.75                     | 05/07/2025    |              |
| 25-04-05467-009   | 7-VHS-WC         | 04/24/2025      | CAFE 2 HALL         | <1.00                    | 05/07/2025    |              |
| 25-04-05467-010   | 7A-VHS-BF        | 04/24/2025      | CAFE 2 HALL         | <1.00                    | 05/07/2025    |              |
| 25-04-05467-011   | 8-VHS-WC         | 04/24/2025      | CAFE 1 HALL         | <1.00                    | 05/07/2025    |              |
| 25-04-05467-012   | 8A-VHS-BF        | 04/24/2025      | CAFE 1 HALL         | <1.00                    | 05/07/2025    |              |
| 25-04-05467-013   | 9-VHS-S          | 04/24/2025      | KITCHEN             | 3.28                     | 05/07/2025    |              |

# Environmental Hazards Services, L.L.C

Client Number: 201327  
 Project/Test Address: 1977; VHS; 256 County Rd 513; Glen Gardner, NJ  
 08826

Report Number: 25-04-05467

| Lab Sample Number | Client Sample ID | Collection Date | Collection Location | Concentration ug/L (ppb) | Analysis Date | Narrative ID |
|-------------------|------------------|-----------------|---------------------|--------------------------|---------------|--------------|
| 25-04-05467-014   | 10-VHS-S         | 04/24/2025      | KITCHEN             | 1.87                     | 05/07/2025    |              |
| 25-04-05467-015   | 11-VHS-S         | 04/24/2025      | KITCHEN             | 2.36                     | 05/07/2025    |              |
| 25-04-05467-016   | 12-VHS-S         | 04/24/2025      | KITCHEN             | 16.2                     | 05/07/2025    |              |
| 25-04-05467-017   | 13-VHS-IM        | 04/24/2025      | KITCHEN             | <1.00                    | 05/07/2025    |              |
| 25-04-05467-018   | 16-VHS-BB        | 04/24/2025      | WRESTLING ROOM      | 6.23                     | 05/07/2025    |              |
| 25-04-05467-019   | 17-VHS-IM        | 04/24/2025      | TRAINER ROOM        | 4.15                     | 05/07/2025    |              |
| 25-04-05467-020   | 18-VHS-WC        | 04/24/2025      | GIRLS LOCKER ROOM   | 9.79                     | 05/07/2025    |              |
| 25-04-05467-021   | 19-VHS-WC        | 04/24/2025      | MAINTENANCE         | 1.82                     | 05/07/2025    |              |
| 25-04-05467-022   | 20-VHS-WC        | 04/24/2025      | UPPER GYM LOBBY     | <1.00                    | 05/07/2025    |              |
| 25-04-05467-023   | 20A-VHS-BF       | 04/24/2025      | UPPER GYM LOBBY     | <1.00                    | 05/07/2025    |              |
| 25-04-05467-024   | 23-VHS-WC        | 04/24/2025      | ROOM 250            | 2.01                     | 05/07/2025    |              |
| 25-04-05467-025   | 24-VHS-WC        | 04/24/2025      | ROOM 244            | <1.00                    | 05/07/2025    |              |
| 25-04-05467-026   | 24A-VHS-BF       | 04/24/2025      | ROOM 244            | <1.00                    | 05/07/2025    |              |
| 25-04-05467-027   | 25-VHS-S         | 04/24/2025      | ROOM 244            | 6.64                     | 05/07/2025    |              |
| 25-04-05467-028   | 28-VHS-S         | 04/24/2025      | LIBRARY OFFICE      | 4.49                     | 05/07/2025    |              |
| 25-04-05467-029   | 29-VHS-S         | 04/24/2025      | RM 261              | 7.02                     | 05/07/2025    |              |
| 25-04-05467-030   | 30-VHS-WC        | 04/24/2025      | 259 HALL            | <1.00                    | 05/07/2025    |              |
| 25-04-05467-031   | 30A-VHS-BF       | 04/24/2025      | 259 HALL            | <1.00                    | 05/07/2025    |              |
| 25-04-05467-032   | 31-VHS-WC        | 04/24/2025      | 215 HALL            | <1.00                    | 05/07/2025    |              |
| 25-04-05467-033   | 31A-VHS-BF       | 04/24/2025      | 215 HALL            | <1.00                    | 05/07/2025    |              |

# Environmental Hazards Services, L.L.C

Client Number: 201327  
 Project/Test Address: 1977; VHS; 256 County Rd 513; Glen Gardner, NJ  
 08826

Report Number: 25-04-05467

| Lab Sample Number | Client Sample ID | Collection Date | Collection Location | Concentration ug/L (ppb) | Analysis Date | Narrative ID |
|-------------------|------------------|-----------------|---------------------|--------------------------|---------------|--------------|
| 25-04-05467-034   | 33-VHS-S1        | 04/24/2025      | ROOM 210            | 2.17                     | 05/07/2025    |              |
| 25-04-05467-035   | 33A-VHS-S2       | 04/24/2025      | ROOM 210            | 1.76                     | 05/07/2025    |              |
| 25-04-05467-036   | 34-VHS-S3        | 04/24/2025      | ROOM 210            | 3.12                     | 05/07/2025    |              |
| 25-04-05467-037   | 34A-VHS-S4       | 04/24/2025      | ROOM 210            | 5.16                     | 05/07/2025    |              |
| 25-04-05467-038   | 34B-VHS-S5       | 04/24/2025      | ROOM 210            | 7.81                     | 05/07/2025    |              |
| 25-04-05467-039   | 35-VHS-S         | 04/24/2025      | ROOM 212            | 6.52                     | 05/07/2025    |              |
| 25-04-05467-040   | 38-VHS-S         | 04/24/2025      | SCIENCE OFFICE      | 30.6                     | 05/07/2025    |              |
| 25-04-05467-041   | 39-VHS-WC        | 04/24/2025      | 318 HALL            | 1.93                     | 05/07/2025    |              |
| 25-04-05467-042   | 40-VHS-WC        | 04/24/2025      | 324 HALL            | <1.00                    | 05/07/2025    |              |
| 25-04-05467-043   | 40A-VHS-BF       | 04/24/2025      | 324 HALL            | <1.00                    | 05/07/2025    |              |
| 25-04-05467-044   | 41-VHS-IM        | 04/24/2025      | 246 CUSTODIAN       | <1.00                    | 05/07/2025    |              |
| 25-04-05467-045   | 42-VHS-S         | 04/24/2025      | CONTROL SAMPLE      | <1.00                    | 05/07/2025    |              |

Method: EPA 200.8  
 Analyst: Nicole Holloway  
 Accreditation #: NJ VA008

Reviewed By Authorized Signatory: *Melissa Kanode*

Melissa Kanode  
 QA/QC Clerk

Sample Results denoted with a "less than" (<) sign contain less than the reporting limit which is 1 ppb.

The EPA Maximum Contaminant Level for Lead in Drinking Water is 15 ppb. The results herein conform to NELAC standards, where applicable, unless otherwise narrated on this report. Results represent the analysis of samples submitted by the client. Sample location, description, field parameter results, etc., were provided by the client. This report cannot be reproduced, except in full, without written approval from Environmental Hazards Services, L.L.C.

LEGEND                      ug/L= micrograms per liter                      ppb = parts per billion



**EHS Laboratories**  
 ENVIRONMENTAL HAZARDS SERVICES, LLC

ONLINE CLIENT PORTAL AVAILABLE FOR ANALYSIS RESULTS AT: [www.leadlab.com](http://www.leadlab.com)

# Water Chain-of-Custody Form

1 of 3

SHIP TO: 7469 Whitepine Rd, Richmond, VA 23237  
 Phone: (800) 347-4010 FAX: (804) 275-4907

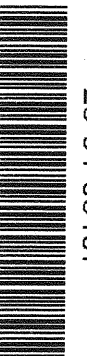

25-04-05467

Company Name: LEW Environmental Services LLC Account #: 201327

Address: 181 US Highway 46 City/State/Zip: Mine Hill, NJ 07803

Phone: (908) 654-8068 Email: [labresults@lewenvironmental.com](mailto:labresults@lewenvironmental.com) Fax: 908-654-8069

Due Date: 05/07/2025 (Wednesday) AE

Project Name / Collection Address: VHS 2516 County Rd 513 City/State/zip: Glen Gardner, NJ 08826 (Required)

Project #: 1977 Sampled By: Cindy DiMeo License # (if Required):

Water Source: (Check One) Public  Well  Well Tag # (if Applicable):

5 Day Turnaround   
  3 Day Turnaround   
  2 Day Turnaround   
  1 Day Turnaround \* Call Ahead

| No. | Client Sample ID | Collection Location (Ex: Kitchen Sink) | Collection Date | Collection Time | Metals |              | Field Parameters                |                              | LAB USE |
|-----|------------------|--|-----------------|-----------------|--------|--------------|---------------------------------|------------------------------|---------|
|     |                  |  |                 |                 | Lead   | Copper Other | Field pH at time of Collection: | Temp. at time of Collection: |         |
| 1   | 1-VHS-S          | Room 165                               | 4/24/25         | 12:00           | AM/PM  | ✓            |                                 |                              |         |
| 2   | 1A-VHS-WC        | Outside Rm 165                         |                 |                 | AM/PM  | ✓            |                                 |                              |         |
| 3   | 2-VHS-S          | Room 163                               |                 |                 | AM/PM  | ✓            |                                 |                              |         |
| 4   | 2A-VHS-WC        | Across from Theater                    |                 |                 | AM/PM  | ✓            |                                 |                              |         |
| 5   | 2B-VHS-BF        | Across from Theater                    |                 |                 | AM/PM  | ✓            |                                 |                              |         |
| 6   | 3-VHS-S          | Nurse                                  |                 |                 | AM/PM  | ✓            |                                 |                              |         |
| 7   | 4-VHS-WC         | Nurse                                  |                 |                 | AM/PM  | ✓            |                                 |                              |         |
| 8   | 6-VHS-S          | Guidance Rm 132                        |                 |                 | AM/PM  | ✓            |                                 |                              |         |
| 9   | 7-VHS-WC         | Cafe 2 Hall                            |                 |                 | AM/PM  | ✓            |                                 |                              |         |
| 10  | 7A-VHS-BF        | Cafe 2 Hall                            |                 |                 | AM/PM  | ✓            |                                 |                              |         |

Released by: Cindy DiMeo Signature: Cindy DiMeo Date/Time: 4/25/25 6:00 PM  
 Released by: Jonathan McEvoy Signature: Jonathan McEvoy Date/Time: 4/30/25 10:41 AM

Client Name: VHS Page 2 of 3

Order # 1977

05467

| No. | Client Sample ID | Collection Location<br>(Ex: Kitchen Sink) | Collection Date | Collection Time | Metals |        |       | Field Parameters                |                              | LAB USE |
|-----|------------------|---|-----------------|-----------------|--------|--------|-------|---------------------------------|------------------------------|---------|
|     |                  |   |                 |                 | Lead   | Copper | Other | Field pH at time of Collection: | Temp. at time of Collection: |         |
| 11  | 8-VHS-WC         | Cafe 1 Hall                               | 4/24/25         | 12:00           | AM/PM  | ✓      |       |                                 |                              |         |
| 12  | 8A-VHS-BF        | Cafe 1 Hall                               |                 |                 | AM/PM  | ✓      |       |                                 |                              |         |
| 13  | 9-VHS-S          | Kitchen                                   |                 |                 | AM/PM  | ✓      |       |                                 |                              |         |
| 14  | 10-VHS-S         | Kitchen                                   |                 |                 | AM/PM  | ✓      |       |                                 |                              |         |
| 15  | 11-VHS-S         | Kitchen                                   |                 |                 | AM/PM  | ✓      |       |                                 |                              |         |
| 16  | 12-VHS-S         | Kitchen                                   |                 |                 | AM/PM  | ✓      |       |                                 |                              |         |
| 17  | 13-VHS-IM        | Kitchen                                   |                 |                 | AM/PM  | ✓      |       |                                 |                              |         |
| 18  | 16-VHS-BB        | Wrestling Room                            |                 |                 | AM/PM  | ✓      |       |                                 |                              |         |
| 19  | 17-VHS-IM        | Trainer Room                              |                 |                 | AM/PM  | ✓      |       |                                 |                              |         |
| 20  | 18-VHS-WC        | Girls Locker Room                         |                 |                 | AM/PM  | ✓      |       |                                 |                              |         |
| 21  | 19-VHS-WC        | Maintenance                               |                 |                 | AM/PM  | ✓      |       |                                 |                              |         |
| 22  | 20-VHS-WC        | Upper Gym Lobby                           |                 |                 | AM/PM  | ✓      |       |                                 |                              |         |
| 23  | 20A-VHS-BF       | Upper Gym Lobby                           |                 |                 | AM/PM  | ✓      |       |                                 |                              |         |
| 24  | 23-VHS-WC        | Room 250                                  |                 |                 | AM/PM  | ✓      |       |                                 |                              |         |
| 25  | 24-VHS-WC        | Room 244                                  |                 |                 | AM/PM  | ✓      |       |                                 |                              |         |
| 26  | 24A-VHS-BF       | Room 244                                  |                 |                 | AM/PM  | ✓      |       |                                 |                              |         |
| 27  | 25-VHS-S         | Room 244                                  |                 |                 | AM/PM  | ✓      |       |                                 |                              |         |
| 28  | 28-VHS-S         | Library Office                            |                 |                 | AM/PM  | ✓      |       |                                 |                              |         |
| 29  | 29-VHS-S         | Rm 261                                    |                 |                 | AM/PM  | ✓      |       |                                 |                              |         |
| 30  | 30-VHS-WC        | 259 Hall                                  |                 |                 | AM/PM  | ✓      |       |                                 |                              |         |

EDUP: Vohrahar MEIN

4/30/25 10:41 Am

05467

Client Name: VHS

Page 3 of 3

Order # 1977

| No. | Client Sample ID | Collection Location<br>(Ex: Kitchen Sink) | Collection Date | Collection Time | Metals |        |       | Field Parameters                |                              | LAB USE |
|-----|------------------|---|-----------------|-----------------|--------|--------|-------|---------------------------------|------------------------------|---------|
|     |                  |   |                 |                 | Lead   | Copper | Other | Field pH at time of Collection: | Temp. at time of Collection: |         |
| 31  | 30A-VHS-BF       | 259 Hall                                  | 4/24/25         | 12:00           | AM/PM  | ✓      |       |                                 |                              |         |
| 32  | 31-VHS-MC        | 215 Hall                                  |                 |                 | AM/PM  | ✓      |       |                                 |                              |         |
| 33  | 31A-VHS-BF       | 215 Hall                                  |                 |                 | AM/PM  | ✓      |       |                                 |                              |         |
| 34  | 33-VHS-S1        | Room 210                                  |                 |                 | AM/PM  | ✓      |       |                                 |                              |         |
| 35  | 33A-VHS-S2       | Room 210                                  |                 |                 | AM/PM  | ✓      |       |                                 |                              |         |
| 36  | 34-VHS-S3        | Room 210                                  |                 |                 | AM/PM  | ✓      |       |                                 |                              |         |
| 37  | 34A-VHS-S4       | Room 210                                  |                 |                 | AM/PM  | ✓      |       |                                 |                              |         |
| 38  | 34B-VHS-S5       | Room 210                                  |                 |                 | AM/PM  | ✓      |       |                                 |                              |         |
| 39  | 35-VHS-S         | Room 212                                  |                 |                 | AM/PM  | ✓      |       |                                 |                              |         |
| 40  | 38-VHS-S         | Science Office                            |                 |                 | AM/PM  | ✓      |       |                                 |                              |         |
| 41  | 39-VHS-MC        | 318 Hall                                  |                 |                 | AM/PM  | ✓      |       |                                 |                              |         |
| 42  | 4D-VHS-MC        | 324 Hall                                  |                 |                 | AM/PM  | ✓      |       |                                 |                              |         |
| 43  | 40A-VHS-BF       | 324 Hall                                  |                 |                 | AM/PM  | ✓      |       |                                 |                              |         |
| 44  | 41-VHS-IM        | 246 Custodian                             |                 |                 | AM/PM  | ✓      |       |                                 |                              |         |
| 45  | 42-VHS-S         | Teacher Room                              |                 |                 | AM/PM  | ✓      |       |                                 |                              |         |
| 46  |                  |   |                 |                 | AM/PM  |        |       |                                 |                              |         |
| 47  |                  |   |                 |                 | AM/PM  |        |       |                                 |                              |         |
| 48  |                  |   |                 |                 | AM/PM  |        |       |                                 |                              |         |
| 49  |                  |   |                 |                 | AM/PM  |        |       |                                 |                              |         |
| 50  |                  |   |                 |                 | AM/PM  |        |       |                                 |                              |         |

REVD: Jonathan Wilson 4/25/25

4/30/25 10:41 AM PM



7469 Whitepine Rd  
 North Chesterfield, VA 23237  
 Telephone: 800.347.4010

## Lead in Drinking Water Analysis Report

Report Number: 25-04-05472

Client: LEW Corp  
 181 US Hwy 46  
 Mine Hill, NJ 07803

Received Date: 04/30/2025  
 Reported Date: 05/08/2025  
 Sampled By: Cindy DiMeo  
 Tech Certification #:

Project/Test Address: 1977; NHRHS; 1445 State Rt 31; South Annandale, NJ 08801

Client Number:  
 201327

# Laboratory Results

Fax Number:  
 Ext 18 Melissa

| Lab Sample Number | Client Sample ID | Collection Date | Collection Location | Concentration ug/L (ppb) | Analysis Date | Narrative ID |
|-------------------|------------------|-----------------|---------------------|--------------------------|---------------|--------------|
| 25-04-05472-001   | 1-NHRHS-S        | 04/24/2025      | KITCHEN             | 1.89                     | 05/08/2025    |              |
| 25-04-05472-002   | 2-NHRHS-S        | 04/24/2025      | KITCHEN             | 1.64                     | 05/07/2025    |              |
| 25-04-05472-003   | 3-NHRHS-S        | 04/24/2025      | KITCHEN             | 1.48                     | 05/07/2025    |              |
| 25-04-05472-004   | 4-NHRHS-S        | 04/24/2025      | KITCHEN             | 2.40                     | 05/07/2025    |              |
| 25-04-05472-005   | 5-NHRHS-WC       | 04/24/2025      | FACULTY DINING      | 2.56                     | 05/07/2025    |              |
| 25-04-05472-006   | 6-NHRHS-WC       | 04/24/2025      | CAFE A LEFT         | 2.20                     | 05/07/2025    |              |
| 25-04-05472-007   | 7-NHRHS-WC       | 04/24/2025      | CAFE A RIGHT        | 12.3                     | 05/07/2025    |              |
| 25-04-05472-008   | 8-NHRHS-WC       | 04/24/2025      | CAFE B LEFT         | 2.31                     | 05/07/2025    |              |
| 25-04-05472-009   | 10-NHRHS-IM      | 04/24/2025      | KITCHEN             | <1.00                    | 05/07/2025    |              |
| 25-04-05472-010   | 11-NHRHS-WC      | 04/24/2025      | HALL A LEFT         | <1.00                    | 05/07/2025    |              |
| 25-04-05472-011   | 11A-NHRHS-WC     | 04/24/2025      | HALL A RIGHT WC     | <1.00                    | 05/07/2025    |              |

# Environmental Hazards Services, L.L.C

Client Number: 201327

Report Number: 25-04-05472

Project/Test Address: 1977; NHRHS; 1445 State Rt 31; South Annandale, NJ  
08801

| Lab Sample Number | Client Sample ID | Collection Date | Collection Location | Concentration ug/L (ppb) | Analysis Date | Narrative ID |
|-------------------|------------------|-----------------|---------------------|--------------------------|---------------|--------------|
| 25-04-05472-012   | 11B-NHRHS-BF     | 04/24/2025      | HALL A RIGHT BF     | <1.00                    | 05/07/2025    |              |
| 25-04-05472-013   | 14A-NHRHS-WC     | 04/24/2025      | OUTSIDE CAFE A      | <1.00                    | 05/07/2025    |              |
| 25-04-05472-014   | 14B-NHRHS-BF     | 04/24/2025      | OUTSIDE CAFE A      | <1.00                    | 05/07/2025    |              |
| 25-04-05472-015   | 15-NHRHS-S1      | 04/24/2025      | ROOM 229            | 1.60                     | 05/08/2025    |              |
| 25-04-05472-016   | 15A-NHRHS-S2     | 04/24/2025      | ROOM 229            | 1.34                     | 05/07/2025    |              |
| 25-04-05472-017   | 15B-NHRHS-S3     | 04/24/2025      | ROOM 229            | 2.71                     | 05/08/2025    |              |
| 25-04-05472-018   | 16-NHRHS-S4      | 04/24/2025      | ROOM 229            | 4.13                     | 05/08/2025    |              |
| 25-04-05472-019   | 16A-NHRHS-S5     | 04/24/2025      | ROOM 229            | 2.65                     | 05/08/2025    |              |
| 25-04-05472-020   | 16B-NHRHS-S6     | 04/24/2025      | ROOM 229            | 1.47                     | 05/07/2025    |              |
| 25-04-05472-021   | 17-NHRHS-WC      | 04/24/2025      | HALL A-2            | <1.00                    | 05/07/2025    |              |
| 25-04-05472-022   | 18-NHRHS-WC      | 04/24/2025      | HALL A-2            | <1.00                    | 05/07/2025    |              |
| 25-04-05472-023   | 18A-NHRHS-BF     | 04/24/2025      | HALL A-2            | <1.00                    | 05/07/2025    |              |
| 25-04-05472-024   | 19-NHRHS-BB      | 04/24/2025      | OUTSIDE RM 223      | 4.55                     | 05/07/2025    |              |
| 25-04-05472-025   | 19B-NHRHS-BB     | 04/24/2025      | OUTSIDE RM 223      | 5.41                     | 05/07/2025    |              |
| 25-04-05472-026   | 20-NHRHS-WC      | 04/24/2025      | HALL C              | 5.63                     | 05/07/2025    |              |

# Environmental Hazards Services, L.L.C

Client Number: 201327

Report Number: 25-04-05472

Project/Test Address: 1977; NHRHS; 1445 State Rt 31; South Annandale, NJ  
08801

| Lab Sample Number | Client Sample ID | Collection Date | Collection Location | Concentration ug/L (ppb) | Analysis Date | Narrative ID |
|-------------------|------------------|-----------------|---------------------|--------------------------|---------------|--------------|
| 25-04-05472-027   | 21-NHRHS-WC      | 04/24/2025      | HALL C2             | 7.31                     | 05/07/2025    |              |
| 25-04-05472-028   | 22-NHRHS-BB      | 04/24/2025      | HALL A2 LEFT        | 1.83                     | 05/07/2025    |              |
| 25-04-05472-029   | 23-NHRHS-BB      | 04/24/2025      | HALL A2 RIGHT       | 2.03                     | 05/07/2025    |              |
| 25-04-05472-030   | 24-NHRHS-S       | 04/24/2025      | RM 121              | 3.10                     | 05/07/2025    |              |
| 25-04-05472-031   | 25-NHRHS-WC      | 04/24/2025      | RM 121              | 1.58                     | 05/07/2025    |              |
| 25-04-05472-032   | 28-NHRHS-WC      | 04/24/2025      | RM 128              | <1.00                    | 05/07/2025    |              |
| 25-04-05472-033   | 29-NHRHS-WC      | 04/24/2025      | WEIGHT ROOM         | <1.00                    | 05/07/2025    |              |
| 25-04-05472-034   | 29A-NHRHS-IM     | 04/24/2025      | RM 026              | <1.00                    | 05/07/2025    |              |
| 25-04-05472-035   | 30-NHRHS-WC      | 04/24/2025      | RM 026              | <1.00                    | 05/07/2025    |              |
| 25-04-05472-036   | 30A-NHRHS-WC     | 04/24/2025      | RM 026              | <1.00                    | 05/08/2025    |              |
| 25-04-05472-037   | 30B-NHRHS-BF     | 04/24/2025      | RM 026              | <1.00                    | 05/07/2025    |              |
| 25-04-05472-038   | 31-NHRHS-BB      | 04/24/2025      | RM 130              | 4.70                     | 05/07/2025    |              |
| 25-04-05472-039   | 31A-NHRHS-S      | 04/24/2025      | RM 130              | 1.32                     | 05/07/2025    |              |

# Environmental Hazards Services, L.L.C

Client Number: 201327

Report Number: 25-04-05472

Project/Test Address: 1977; NHRHS; 1445 State Rt 31; South Annandale, NJ  
08801

| Lab Sample Number | Client Sample ID | Collection Date | Collection Location | Concentration ug/L (ppb) | Analysis Date | Narrative ID |
|-------------------|------------------|-----------------|---------------------|--------------------------|---------------|--------------|
| 25-04-05472-040   | 32-NHRHS-S       | 04/24/2025      | NURSE OFFICE        | 7.12                     | 05/07/2025    |              |
| 25-04-05472-041   | 33-NHRHS-S       | 04/24/2025      | NURSE OFFICE        | 1.75                     | 05/08/2025    |              |
| 25-04-05472-042   | 36-NHRHS-WC      | 04/24/2025      | HALL D              | <1.00                    | 05/07/2025    |              |
| 25-04-05472-043   | 36A-NHRHS-WC     | 04/24/2025      | HALL D              | <1.00                    | 05/07/2025    |              |
| 25-04-05472-044   | 36B-NHRHS-BF     | 04/24/2025      | HALL D              | <1.00                    | 05/07/2025    |              |
| 25-04-05472-045   | 37-NHRHS-S       | 04/24/2025      | TRAINERS RM         | 3.58                     | 05/07/2025    |              |
| 25-04-05472-046   | 38-NHRHS-IM      | 04/24/2025      | TRAINERS RM         | <1.00                    | 05/07/2025    |              |
| 25-04-05472-047   | 39-NHRHS-WC      | 04/24/2025      | HALL E LEFT         | <1.00                    | 05/07/2025    |              |
| 25-04-05472-048   | 39A-NHRHS-WC     | 04/24/2025      | HALL E LEFT         | <1.00                    | 05/07/2025    |              |
| 25-04-05472-049   | 40-NHRHS-WC      | 04/24/2025      | HALL E RIGHT        | <1.00                    | 05/07/2025    |              |
| 25-04-05472-050   | 40A-NHRHS-WC     | 04/24/2025      | HALL E RIGHT        | <1.00                    | 05/07/2025    |              |
| 25-04-05472-051   | 41-NHRHS-S       | 04/24/2025      | SNACK BAR           | 815                      | 05/08/2025    |              |
| 25-04-05472-052   | 42-NHRHS-BB      | 04/24/2025      | HALL F              | 4.70                     | 05/07/2025    |              |
| 25-04-05472-053   | 44-NHRHS-BB      | 04/24/2025      | HALL G              | 25.3                     | 05/07/2025    |              |

# Environmental Hazards Services, L.L.C

Client Number: 201327  
 Project/Test Address: 1977; NHRHS; 1445 State Rt 31; South Annandale, NJ  
 08801

Report Number: 25-04-05472

| Lab Sample Number | Client Sample ID | Collection Date | Collection Location | Concentration ug/L (ppb) | Analysis Date | Narrative ID |
|-------------------|------------------|-----------------|---------------------|--------------------------|---------------|--------------|
| 25-04-05472-054   | 45-NHRHS-S       | 04/24/2025      | GUIDANCE            | 5.51                     | 05/07/2025    |              |
| 25-04-05472-055   | 46-NHRHS-WC      | 04/24/2025      | HALL G 2            | <1.00                    | 05/07/2025    |              |
| 25-04-05472-056   | 46A-NHRHS-BF     | 04/24/2025      | HALL G 2            | <1.00                    | 05/07/2025    |              |
| 25-04-05472-057   | 47-NHRHS-WC      | 04/24/2025      | ROOM 203            | <1.00                    | 05/07/2025    |              |
| 25-04-05472-058   | 47A-NHRHS-BF     | 04/24/2025      | ROOM 203            | <1.00                    | 05/07/2025    |              |
| 25-04-05472-059   | 48-NHRHS-WC      | 04/24/2025      | HALL H              | <1.00                    | 05/07/2025    |              |
| 25-04-05472-060   | 49-NHRHS-BF      | 04/24/2025      | HALL H              | <1.00                    | 05/07/2025    |              |
| 25-04-05472-061   | 50-NHRHS-S       | 04/24/2025      | CONTROL SAMPLE      | <1.00                    | 05/07/2025    |              |

Method: EPA 200.8  
 Analyst: Nicole Holloway  
 Accreditation #: NJ VA008

Reviewed By Authorized Signatory:



Tasha Eaddy  
 QA/QC Clerk

Sample Results denoted with a "less than" (<) sign contain less than the reporting limit which is 1 ppb.

The EPA Maximum Contaminant Level for Lead in Drinking Water is 15 ppb. The results herein conform to NELAC standards, where applicable, unless otherwise narrated on this report. Results represent the analysis of samples submitted by the client. Sample location, description, field parameter results, etc., were provided by the client. This report cannot be reproduced, except in full, without written approval from Environmental Hazards Services, L.L.C.

LEGEND                      ug/L= micrograms per liter                      ppb = parts per billion



**EHS Laboratories**  
 ENVIRONMENTAL HAZARDS SERVICES, LLC

ONLINE CLIENT PORTAL AVAILABLE FOR ANALYSIS RESULTS AT: [www.leadlab.com](http://www.leadlab.com)

# Water Chain-of-Custody Form 1 of 4

SHIP TO: 7469 Whitepine Rd. Richmond, VA 23237

Phone: (800) 347-4010 FAX: (804) 275-4907

25-04-05472

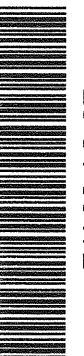

Due Date:  
 05/07/2025  
 (Wednesday)  
 AE

Company Name: LEW Environmental Services LLC

Account #: 201327

Address: 181 US Highway 46

City/State/Zip: Mine Hill, NJ 07803

Phone: (908) 654-8068

Email: [labresults@lewenvironmental.com](mailto:labresults@lewenvironmental.com)

Fax: 908-654-8069

Project Name / Collection Address:

NHRHS 1445 State Rt. 31

City/State/Zip: South Amundale, NJ 08801

(Required)

Project #: 1977

Sampled By: Cindy DiMeo

License # (if Required):

Water Source: (Check One) Public  Well

Well Tag # (if Applicable):

5 Day Turnaround

3 Day Turnaround

2 Day Turnaround

1 Day Turnaround \* Call Ahead

| No. | Client Sample ID | Collection Location<br>(Ex: Kitchen Sink) | Collection Date | Collection Time | Metals                              |                                     |                                     | Field Parameters                |                              | LAB USE |
|-----|------------------|---|-----------------|-----------------|-------------------------------------|-------------------------------------|-------------------------------------|---------------------------------|------------------------------|---------|
|     |                  |   |                 |                 | Lead                                | Copper                              | Other                               | Field pH at time of Collection: | Temp. at time of Collection: |         |
| 1   | 1-NHRHS-S        | Kitchen                                   | 4/24/25         | 7:00 AM         | <input checked="" type="checkbox"/> | <input checked="" type="checkbox"/> | <input checked="" type="checkbox"/> |                                 |                              |         |
| 2   | 2-NHRHS-S        | Kitchen                                   |                 |                 | <input checked="" type="checkbox"/> | <input checked="" type="checkbox"/> | <input checked="" type="checkbox"/> |                                 |                              |         |
| 3   | 3-NHRHS-S        | Kitchen                                   |                 |                 | <input checked="" type="checkbox"/> | <input checked="" type="checkbox"/> | <input checked="" type="checkbox"/> |                                 |                              |         |
| 4   | 4-NHRHS-S        | Kitchen                                   |                 |                 | <input checked="" type="checkbox"/> | <input checked="" type="checkbox"/> | <input checked="" type="checkbox"/> |                                 |                              |         |
| 5   | 5-NHRHS-MC       | Faculty Dining                            |                 |                 | <input checked="" type="checkbox"/> | <input checked="" type="checkbox"/> | <input checked="" type="checkbox"/> |                                 |                              |         |
| 6   | 6-NHRHS-MC       | Cafe A (Left)                             |                 |                 | <input checked="" type="checkbox"/> | <input checked="" type="checkbox"/> | <input checked="" type="checkbox"/> |                                 |                              |         |
| 7   | 7-NHRHS-MC       | Cafe A (Right)                            |                 |                 | <input checked="" type="checkbox"/> | <input checked="" type="checkbox"/> | <input checked="" type="checkbox"/> |                                 |                              |         |
| 8   | 8-NHRHS-MC       | Cafe B (Left)                             |                 |                 | <input checked="" type="checkbox"/> | <input checked="" type="checkbox"/> | <input checked="" type="checkbox"/> |                                 |                              |         |
| 9   | 10-NHRHS-IM      | Kitchen                                   |                 |                 | <input checked="" type="checkbox"/> | <input checked="" type="checkbox"/> | <input checked="" type="checkbox"/> |                                 |                              |         |
| 10  | 11-NHRHS-MC      | Hall A (Left)                             |                 |                 | <input checked="" type="checkbox"/> | <input checked="" type="checkbox"/> | <input checked="" type="checkbox"/> |                                 |                              |         |

Released by: Cindy DiMeo

Signature: Cindy DiMeo

Date/Time: 4/25/25 6:00pm

Released by: Jonathan King

Signature: Jonathan King

Date/Time: 4/30/25 10:49 AM

#05472

Client Name: NHRHS

Page 2 of 4

Order # 1977

| No. | Client Sample ID | Collection Location<br>(Ex: Kitchen Sink) | Collection Date | Collection Time | Metals |        |       | Field Parameters                |                              | LAB USE |
|-----|------------------|---|-----------------|-----------------|--------|--------|-------|---------------------------------|------------------------------|---------|
|     |                  |   |                 |                 | Lead   | Copper | Other | Field pH at time of Collection: | Temp. at time of Collection: |         |
| 11  | 11A-NHRHS-WC     | Hall A (Right WC)                         | 4/24/25         | 7:00            | AM/PM  | ✓      |       |                                 |                              |         |
| 12  | 11B-NHRHS-BF     | Hall A (Right BF)                         |                 |                 | AM/PM  | ✓      |       |                                 |                              |         |
| 13  | 14A-NHRHS-WC     | Outside Cafe A                            |                 |                 | AM/PM  | ✓      |       |                                 |                              |         |
| 14  | 14B-NHRHS-BF     | Outside Cafe A                            |                 |                 | AM/PM  | ✓      |       |                                 |                              |         |
| 15  | 15-NHRHS-S1      | Room 229                                  |                 |                 | AM/PM  | ✓      |       |                                 |                              |         |
| 16  | 15A-NHRHS-S2     | Room 229                                  |                 |                 | AM/PM  | ✓      |       |                                 |                              |         |
| 17  | 15B-NHRHS-S3     | Room 229                                  |                 |                 | AM/PM  | ✓      |       |                                 |                              |         |
| 18  | 16-NHRHS-S4      | Room 229                                  |                 |                 | AM/PM  | ✓      |       |                                 |                              |         |
| 19  | 16A-NHRHS-S5     | Room 229                                  |                 |                 | AM/PM  | ✓      |       |                                 |                              |         |
| 20  | 16B-NHRHS-S6     | Room 229                                  |                 |                 | AM/PM  | ✓      |       |                                 |                              |         |
| 21  | 17-NHRHS-WC      | Hall A-2                                  |                 |                 | AM/PM  | ✓      |       |                                 |                              |         |
| 22  | 18-NHRHS-WC      | Hall A-2                                  |                 |                 | AM/PM  | ✓      |       |                                 |                              |         |
| 23  | 18A-NHRHS-BF     | Hall A-2                                  |                 |                 | AM/PM  | ✓      |       |                                 |                              |         |
| 24  | 19-NHRHS-BB      | Outside Rm 223                            |                 |                 | AM/PM  | ✓      |       |                                 |                              |         |
| 25  | 19B-NHRHS-BB     | Outside Rm 223                            |                 |                 | AM/PM  | ✓      |       |                                 |                              |         |
| 26  | 20-NHRHS-WC      | Hall C                                    |                 |                 | AM/PM  | ✓      |       |                                 |                              |         |
| 27  | 21-NHRHS-WC      | Hall C2                                   |                 |                 | AM/PM  | ✓      |       |                                 |                              |         |
| 28  | 22-NHRHS-BB      | Hall A2 (Left)                            |                 |                 | AM/PM  | ✓      |       |                                 |                              |         |
| 29  | 23-NHRHS-BB      | Hall A2 (Right)                           |                 |                 | AM/PM  | ✓      |       |                                 |                              |         |
| 30  | 24-NHRHS-S       | Rm 121                                    |                 |                 | AM/PM  | ✓      |       |                                 |                              |         |

RAVD: Johnathon Williams  
*Johnathon Williams*  
 4/30/25 10:49 AM

Client Name: NHRHS

Page 3 of 4

Order # 1977

| No. | Client Sample ID | Collection Location<br>(Ex: Kitchen Sink) | Collection Date | Collection Time | Metals |        |       | Field Parameters                |                              | LAB USE |
|-----|------------------|---|-----------------|-----------------|--------|--------|-------|---------------------------------|------------------------------|---------|
|     |                  |   |                 |                 | Lead   | Copper | Other | Field pH at time of Collection: | Temp. at time of Collection: |         |
| 31  | 25-NHRHS-WC      | Room 121                                  | 4/24/25         | 7:00 AM/PM      | ✓      |        |       |                                 |                              |         |
| 32  | 28-NHRHS-WC      | Room 128                                  |                 |                 | ✓      |        |       |                                 |                              |         |
| 33  | 29-NHRHS-WC      | Weight Room                               |                 |                 | ✓      |        |       |                                 |                              |         |
| 34  | 29A-NHRHS-IM     | Room 026                                  |                 |                 | ✓      |        |       |                                 |                              |         |
| 35  | 30-NHRHS-WC      | Room 026                                  |                 |                 | ✓      |        |       |                                 |                              |         |
| 36  | 30A-NHRHS-WC     | Room 026                                  |                 |                 | ✓      |        |       |                                 |                              |         |
| 37  | 30B-NHRHS-BF     | Room 026                                  |                 |                 | ✓      |        |       |                                 |                              |         |
| 38  | 31-NHRHS-BB      | Room 130                                  |                 |                 | ✓      |        |       |                                 |                              |         |
| 39  | 31A-NHRHS-S      | Room 130                                  |                 |                 | ✓      |        |       |                                 |                              |         |
| 40  | 32-NHRHS-S       | Nurse Office                              |                 |                 | ✓      |        |       |                                 |                              |         |
| 41  | 33-NHRHS-S       | Nurse Office                              |                 |                 | ✓      |        |       |                                 |                              |         |
| 42  | 36-NHRHS-WC      | Hall B                                    |                 |                 | ✓      |        |       |                                 |                              |         |
| 43  | 36A-NHRHS-WC     | Hall B                                    |                 |                 | ✓      |        |       |                                 |                              |         |
| 44  | 36B-NHRHS-BF     | Hall B                                    |                 |                 | ✓      |        |       |                                 |                              |         |
| 45  | 37-NHRHS-S       | Trainers Rm                               |                 |                 | ✓      |        |       |                                 |                              |         |
| 46  | 38-NHRHS-IM      | Trainers Rm                               |                 |                 | ✓      |        |       |                                 |                              |         |
| 47  | 39-NHRHS-WC      | Hall E (Left)                             |                 |                 | ✓      |        |       |                                 |                              |         |
| 48  | 39A-NHRHS-WC     | Hall E (Left)                             |                 |                 | ✓      |        |       |                                 |                              |         |
| 49  | 40-NHRHS-WC      | Hall E (Right)                            |                 |                 | ✓      |        |       |                                 |                              |         |
| 50  | 40A-NHRHS-WC     | Hall E (Right)                            |                 |                 | ✓      |        |       |                                 |                              |         |

RECID: Jonathan Wiseman 4/30/25

for 10:49am

Client Name: NHRHS

Page 4 of 4

Order # 1977

| No. | Client Sample ID | Collection Location<br>(Ex: Kitchen Sink) | Collection Date | Collection Time | Metals |        |       | Field Parameters                |                              | LAB USE |
|-----|------------------|---|-----------------|-----------------|--------|--------|-------|---------------------------------|------------------------------|---------|
|     |                  |   |                 |                 | Lead   | Copper | Other | Field pH at time of Collection: | Temp. at time of Collection: |         |
| 51  | 41-NHRHS-S       | Snack Bar                                 | 4/24/25         | 1:00            | AM/PM  |        |       |                                 |                              |         |
| 52  | 42-NHRHS-BB      | Hall F                                    |                 |                 | AM/PM  |        |       |                                 |                              |         |
| 53  | 44-NHRHS-BB      | Hall G                                    |                 |                 | AM/PM  |        |       |                                 |                              |         |
| 54  | 45-NHRHS-S       | Guidance                                  |                 |                 | AM/PM  |        |       |                                 |                              |         |
| 55  | 46-NHRHS-WC      | Hall G2                                   |                 |                 | AM/PM  |        |       |                                 |                              |         |
| 56  | 46A-NHRHS-BF     | Hall G2                                   |                 |                 | AM/PM  |        |       |                                 |                              |         |
| 57  | 47-NHRHS-WC      | Room 203                                  |                 |                 | AM/PM  |        |       |                                 |                              |         |
| 58  | 47A-NHRHS-BF     | Room 203                                  |                 |                 | AM/PM  |        |       |                                 |                              |         |
| 59  | 48-NHRHS-WC      | Hall H                                    |                 |                 | AM/PM  |        |       |                                 |                              |         |
| 60  | 49-NHRHS-BF      | Hall H                                    |                 |                 | AM/PM  |        |       |                                 |                              |         |
| 61  | 50-NHRHS-S       | Teacher Room                              |                 |                 | AM/PM  |        |       |                                 |                              |         |
| 62  |                  |   |                 |                 | AM/PM  |        |       |                                 |                              |         |
| 63  |                  |   |                 |                 | AM/PM  |        |       |                                 |                              |         |
| 64  |                  |   |                 |                 | AM/PM  |        |       |                                 |                              |         |
| 65  |                  |   |                 |                 | AM/PM  |        |       |                                 |                              |         |
| 66  |                  |   |                 |                 | AM/PM  |        |       |                                 |                              |         |
| 67  |                  |   |                 |                 | AM/PM  |        |       |                                 |                              |         |
| 68  |                  |   |                 |                 | AM/PM  |        |       |                                 |                              |         |
| 69  |                  |   |                 |                 | AM/PM  |        |       |                                 |                              |         |
| 70  |                  |   |                 |                 | AM/PM  |        |       |                                 |                              |         |