

ENTERING SCHOOL

Doors will be opened for students at 7:00 a.m. Students may enter through the Route 31 or Regional Road entrance. Students who arrive prior to 7:30 a.m. must report to the Main Gym via the Regional Road entrance or the old gym at the Route 31 entrance. **Students should not be dropped off prior to 7:00 a.m.**

ROUTE 31 AND REGIONAL ROAD TRAFFIC PATTERNS

During the school year, more than 2,000 people are attempting to enter the facility between 7:00 a.m. - 7:45 a.m. This traffic is comprised of senior drivers, staff members, school buses, and parents/guardians. It is vitally important that all vehicles yield to pedestrians and school buses while on campus. The speed limit on campus is 5 miles per hour. Please see the following information on how to enter campus:

- **Route 31**

If you enter from Route 31, make a right and proceed to the Administrative Lot at the north side of the building, traveling to the end then turn left toward the front of the building and then make the right toward the Route 31 Entrance. Proceed to the furthest drop-off location in front of building. All cars must exit onto Route 31 south (see map below). An employee will be directing traffic in front of the building. Clinton Township Police will be assisting as well.

- **Regional Road**

Cars using the Regional Road entrance must drop off students at the District Office parking lot. Drivers should then proceed out the lower bus lot onto Regional Road (see map below). The campus traffic circle is to remain clear for school buses. Crosswalks have been laid out to remind motorists that pedestrians always have the right of way.

Traffic Pattern

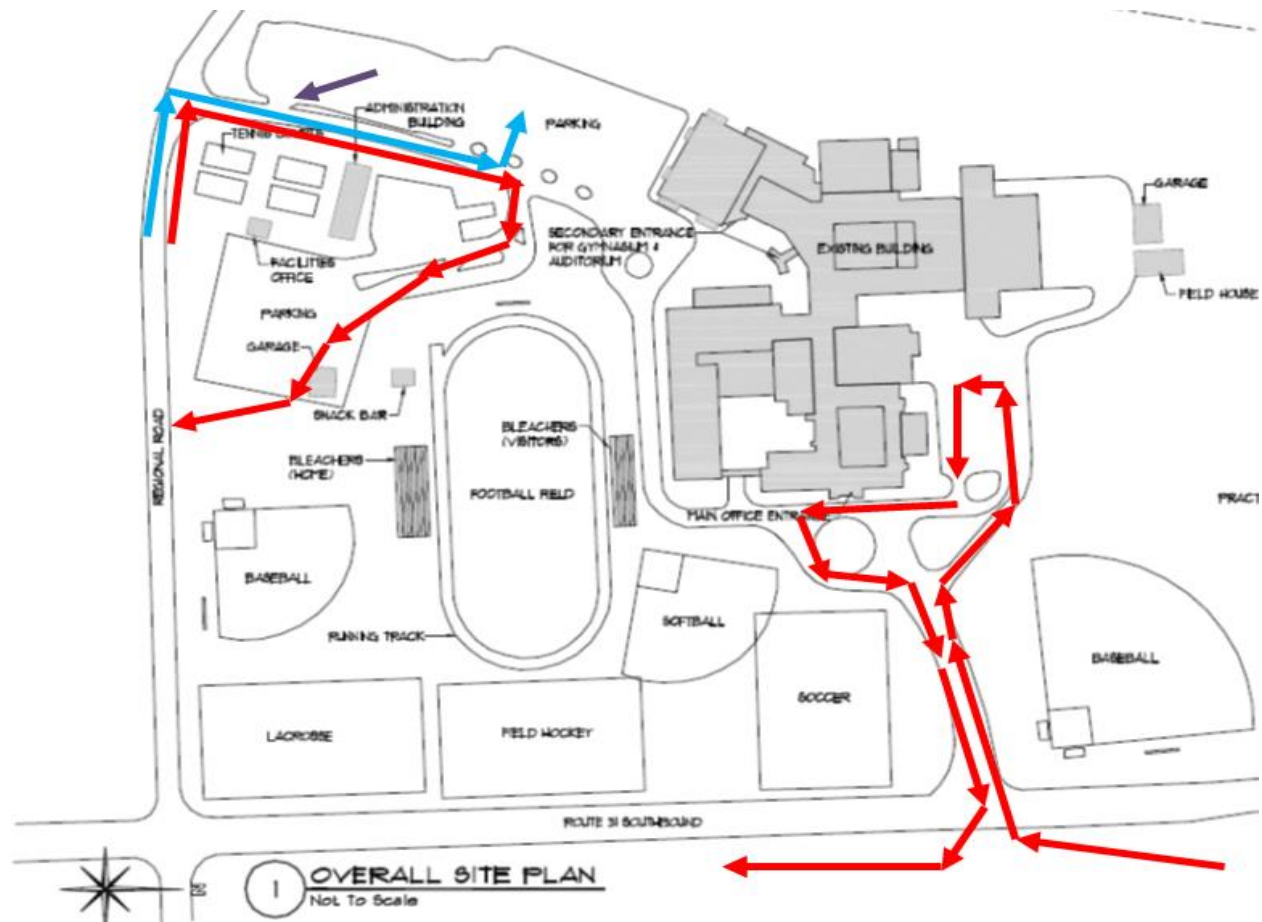

Legend:

Parents entering and leaving pattern Seniors parking pattern Seniors leaving pattern.