

# ***NORTH HUNTERDON HIGH SCHOOL***

*Michael P. Hughes*  
*Principal*

*John P. Hahola, Jr.*  
*Assistant Principal*

*Irene Dolan*  
*Assistant Principal*



*Patricia Raleigh*  
*Director of Guidance*

*John Deutsch*  
*Director of Athletics*

*Michael Gleason*  
*Dean of Students*  
*Health/PE Supervisor*

September 12, 2008

Dear Parents, Guardians and Students:

Now that we are two weeks into the new school year, we have noticed that there is much congestion at both of our school entrances in the morning, particularly between 7:20 a.m. and 7:40 a.m. Though this congestion is nothing new, it has unfortunately caused several buses to arrive late this year, sometimes dropping off students after the warning bell has rung.

While our transportation department has adjusted pick up times on some bus routes, traffic around the high school is usually the main cause of late arrival of buses. We have hundreds of students and parents trying to enter our campus at the same time our buses are arriving. In order to lessen the congestion so our buses may more efficiently drop off students, we offer the following suggestions:

- Our buses arrive between 7:25 a.m. and 7:35 a.m. through the Regional Road entrance. **Seniors driving to school should aim to be in the parking lot prior to 7:25 a.m. as they share the same entrance as our buses. This will greatly help alleviate the congestion at the Regional Road entrance.**
- All parents dropping off students should try to enter through the Route 31 entrance in order to minimize the amount of cars entering from Regional Road. (Please see traffic map) If you choose to enter from Regional Road, please drop off your students before 7:25 a.m. Reminder: you cannot go into the circle while buses are arriving and must drop off in District office parking lot.
- All parents dropping off students should try to do so before 7:30 a.m. This will help lighten the line of cars which can back up onto Route 31, causing traffic to slow on Route 31 South.
- Reminder: students may enter the school via the **NEW GYM** entrance as early as 7:00 a.m., but must wait in the new gym until 7:15 a.m. before being released into the building.
- **Parents should consider encouraging their children to ride the bus.** This will also help lighten the amount of cars at the Route 31 entrance.

By arriving earlier to school, you are not only helping to ease the arrival of our buses, but you are also helping to protect the safety of our students. With so many cars and buses driving into campus in the morning, it can be a chaotic scene so it is essential that you be vigilant of students walking into the school and observe the 5 mph speed limit.

Thank you for your understanding and assistance with this matter.

Sincerely,

Michael P. Hughes  
Principal

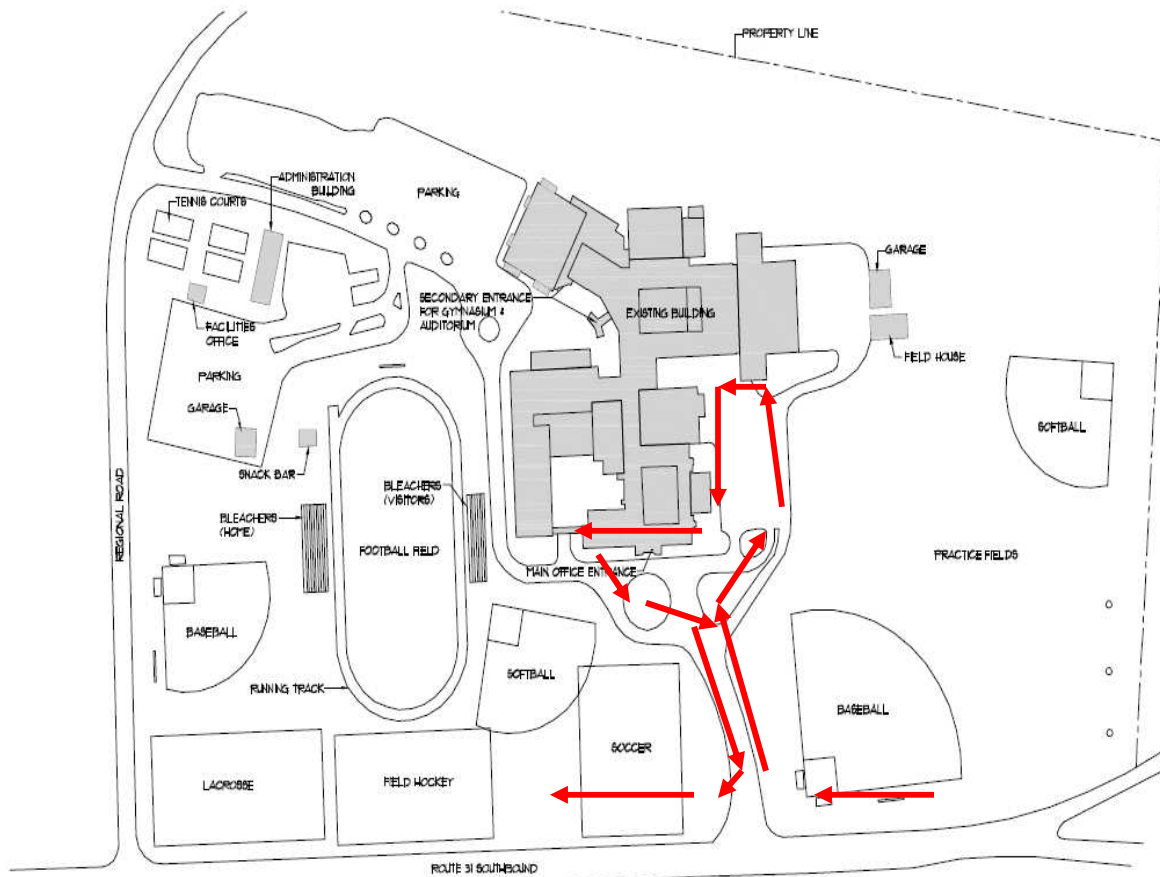

1 OVERALL SITE PLAN  
Not To Scale