

NORTH HUNTERDON HIGH SCHOOL

Michael P. Hughes
Principal

John P. Hahola, Jr.
Assistant Principal

Irene Dolan
Assistant Principal



Patricia Raleigh
Director of Guidance

John Deutsch
Director of Athletics

Michael Gleason
Dean of Students
Health/PE Supervisor

August, 2009

Dear Parents, Guardians, and Students:

Welcome to the 2009-2010 school year. The following information highlights significant events and dates that will make the transition to the new school year successful.

SCHOOL OPENING DETAILS

FRESHMEN

Freshmen will report to their Alpha homerooms for an orientation program on **Wednesday, August 26th** at 12:30 p.m. Bus pick-up will be exactly **five hours** later than the scheduled pick-up time on the students' transportation cards. Students should be at the bus stop at least five minutes prior to pick-up. Dismissal is scheduled for 3:10 p.m. Bus cards will be mailed in August.

ALL OTHER STUDENTS

All students report for a REGULAR school day on **Thursday, August 27th**. Students will report to their Alpha homerooms. The Alpha homeroom teachers will provide students with their class schedules, and school opening information will be provided at this time. Guidance counselors completed all necessary student schedule revisions during the summer. To ensure an orderly opening of school, all student schedules are final. Specific individual concerns should be directed to your child's school counselor by appointment.

BACK TO SCHOOL NIGHTS

This year we will have two scheduled Back to School Nights. Parents of students whose last names begin with (A-L) are invited to attend on Thursday, September 10th. Parents of students (M-Z) are invited to attend on Tuesday, September 15th. The program on both evenings will begin in the New Gymnasium at 6:30 p.m. Parents are reminded to bring a copy of their students' schedules to this popular year-opening event.

WHAT'S HAPPENING AT NORTH?

- Enrollment is 1,871 students.
- School lunches this year will be \$3.25.

1445 Route 31, Annandale, N.J. 08801 – Telephone 908-735-5191, Fax 908-735-6447

www.nhvweb.net/nhhs/

- Daily announcements, athletic schedules and the latest happenings at North are included on our web site at <http://www.nhvweb.net/NHHS> . Most required forms can be downloaded from the site. Also, current contact information for all staff is available on our site. Please visit our site regularly.
- Comcast Channel 25, North Hunterdon's television station, is up and running. Check the scrolling message board for delayed openings or closings, important events at North, and policy reminders. This year we will begin broadcasting student-produced programming.
- The best source of information about what is going on at North is your child; we encourage you to regularly discuss with your child the events of their day at North Hunterdon High School.

NEW COURSE

- English III is a new course being offered this year. This course is required for all Juniors.

PROJECT ACCELERATION

Information regarding participating in Project Acceleration will be available in class in late September or early October.

REQUIRED SUMMER READING TESTING

All students will be tested on their summer reading on Friday, **September 4, 2009**, during their English classes. Students who are not scheduled for a first semester English course will be scheduled to go to the Reading-Writing Lab (Rm. 106) to take their tests on Tuesday and Wednesday, September 8 and 9, 2009.

REQUIRED 11TH GRADE MATH ASSIGNMENT

Math HSPA Booklet – Each current **junior** was given a Math HSPA Review Booklet to be completed over the summer and submitted to a math teacher in September. This reminder is to emphasize it is the student's responsibility to return this booklet to the math department.

ID CARD POLICY

Students are to carry ID cards at all times while in school and at all school activities and functions. Students must present ID's when asked to do so by staff members. Failure to do so may result in a disciplinary referral. Students must present ID's when entering Guidance, the Reading/Writing Lab, departmental resource centers, the Health Office, and the Media Center.

SENIOR PARKING

Our parking areas may not accommodate all senior drivers. As in previous years, parking must be limited only to seniors in good standing according to established procedures (see below). A parking lottery in the fall and another in the spring will likely determine which seniors will be able to park on campus.

- The Board of Education has established a \$25 per semester parking fee.
- All Cooperative Instructional Education students automatically receive a parking permit. This program is curricular and requires students to drive to off-campus work sites.
- Parents and students must have attended Alive @ 25 Program.
- Parking spots are awarded via random lottery of licensed seniors, who are drivers in good standing. "Good standing" is defined as any student who has regular attendance and no disciplinary referrals in the previous semester. All students are aware of this expectation.
- Students must complete an application for inclusion in the lottery in the Attendance Office.
- In the second semester, the lottery process is repeated with priority given to students who did not get a first semester parking permit. The intent is that each eligible senior will have driving privileges at least one semester of his/her senior year.

SECURE YOUR BELONGINGS

Most people who have lost items in school did not lock up their belongings. Do not bring expensive items like iPods to school. **DO NOT SHARE LOCKERS**. If your locker is not working properly, see Ms. Dolan, Assistant Principal, for help.

BULLYING AND HARASSMENT are illegal. We are a community at North, and we expect our students to treat their classmates the way they would like to be treated. However, some students feel the need to belittle and taunt others. That behavior is not acceptable, and those who bully and harass others face stringent discipline and even legal consequences.

PARENTAL INVOLVEMENT

We encourage parent involvement at North. Listed below are examples of committees and organizations that are available for parental participation.

- Middle States Accreditation Committee
- Parent Advisory Committee
- Parent Teacher Student Organization
- Parent Music Association
- Athletic Boosters
- Special Education Advisory Committee

If you are interested in being involved in our programs, please call the Principal's secretary, Mrs. Mary Umhoefer at (908) 713-4122.

Please mark your calendar for the first **Parent Advisory Committee**, which is scheduled for Thursday, September 17, 2009, from 9:30-11:00 a.m. in the Theatre.

SCHOOL MESSENGER

Our district uses this notification system to alert parents of school closings, delayed openings, emergencies, and also to email timely information. Please take a moment to check your contact information in School Messenger. (Parents of incoming freshman: you will receive a separate letter regarding how to sign-up for School Messenger.) In an effort to go green, we will be using School Messenger even more this year to email letters from the Principal instead of mailing them home. Therefore, it is important that we have your correct contact information, particularly email address, in the system. Last year, we had email addresses that were missing or that were typed incorrectly. To sign-in and verify your contact information, please visit: <https://contactme.schoolmessenger.com>. If you change or add to your contact information, please also send those changes/additions to our registrar, Sue Gutwillig, at sgutwillig@nhvweb.net. Information entered in Messenger does not automatically update into our student database.

AGENDA PLANNING BOOK

In order to provide assistance in organization and study skills, an agenda planning book will be given to every student during the first week of school. This book will allow students to record homework assignments and mark important calendar dates.

STUDENT/PARENT HANDBOOK

The Student/Parent Handbook was developed as an information resource. It explains procedures, opportunities for student involvement, and student's rights and obligations. The handbook is available online at <http://www.nhvweb.net/NHHS/>. The link is on the left side of the home page.

VISITING NORTH HUNTERDON HIGH SCHOOL

During school hours, all visitors will enter the building through the Route 31 entrance or through the Regional Road entrance. Security guards are on duty at both entrances. Visitors must stop at the security desk to sign in. The security personnel then will provide a visitor's pass, which must be visible at all times while on campus. Visitors who are not wearing a pass will be escorted to the main office. At the end of the visit, visitors will sign out at the same security desk where they signed in. Alumni visitors who wish to visit specific teachers should schedule their visits after 2:30 p.m. A call to the teachers in advance would be courteous. Your cooperation in following these procedures assists us in our efforts to maintain a safe environment.

SCHOOL CALENDAR

The school calendar is available on the school web-site. Please be reminded that all events are subject to change. Latest information will be available on our web site <http://www.nhvweb.net/NHHS/>.

ENTERING SCHOOL

Doors will be opened for students at 7:15 a.m. Students may enter through the Route 31 or Regional Road entrance. Students who arrive prior to 7:15 a.m. must report to the New Gym via the Regional Road entrance. Students may enter the New Gym at 7:00 a.m. Students should not be dropped off at the Route 31 entrance prior to 7:15 a.m.

ROUTE 31 AND REGIONAL ROAD TRAFFIC PATTERNS

As you are aware, North Hunterdon's student and staff population has grown significantly over the last seven years, and this growth is predicted to continue. Currently, more than 2200 people are attempting to enter the facility between 7:00 A.M. - 7:45 A.M. This traffic is comprised of senior drivers, staff members, school buses, and parents/guardians.

ROUTE 31

Please enter campus from Route 31. Make a right and proceed to the Administrative Lot at the north side of the building, traveling to the end. Turn left toward the front of the building and then make the right toward the Route 31 Entrance. Proceed to the furthest drop-off location. All cars must exit onto Route 31 south. An employee will be directing traffic in front of the building. Clinton Township police will be assisting as well. Remember that the speed limit on campus is 5 miles per hour.

ROUTE 31 TRAFFIC PATTERN

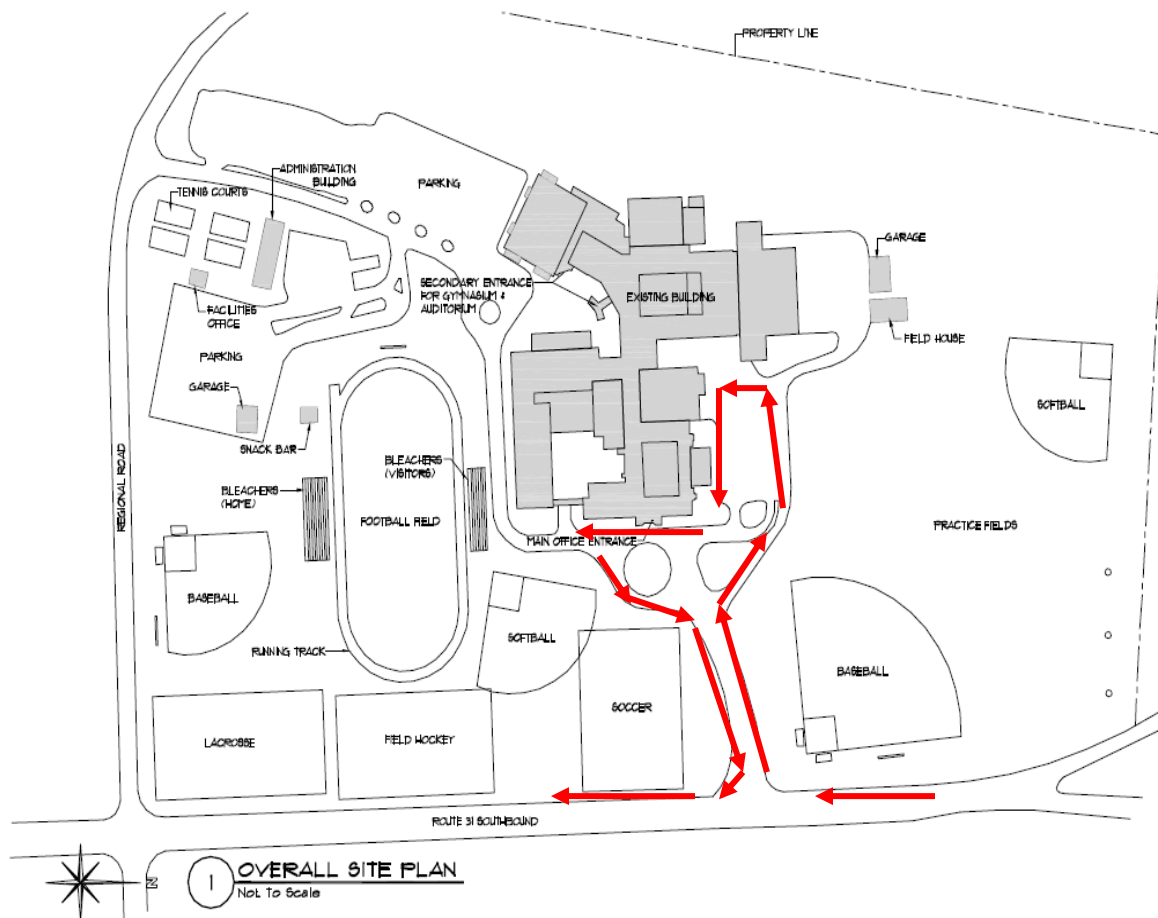

REGIONAL ROAD

Cars using the Regional Road entrance must drop off students at the District Office parking lot. Drivers should then proceed out the Regional Road exit. The campus traffic circle is to remain clear for school buses. Crosswalks have been laid out to remind motorists that pedestrians always have the right of way. All vehicles while on campus must yield to pedestrians and school buses. The speed limit on campus is 5 miles per hour.

The students should be dropped off by parents/guardians before 7:20 a.m., and picked up after 2:45 p.m. This should eliminate the bottlenecks that have been created on Route 31 and Regional Road and allow for a more uniform and safe environment for students, staff members, school buses and parents/guardians. Your support of our efforts to maintain a safe environment is appreciated.

LEAVING SCHOOL AT DISMISSAL

To avoid a potential disaster, only buses will be allowed to exit through the Regional Road exit from 2:25 to 2:35 p.m. Senior drivers will be dismissed after all buses have exited campus. From 2:25 to 2:35 p.m. parents may only pick up students on the Route 31 side of the building. No cars should be standing around the circle on the Regional Road side. Parking in any fire lanes is prohibited. Parking in the District parking lot is prohibited.

See the diagram on the following page for the Route 31 traffic pattern for leaving the school at dismissal.

DRESS CODE

The home and school need to cooperate in the matter of student attire. In order to create a positive school atmosphere, attire and grooming should be reasonably modest and neat. A student's appearance must not disrupt the teaching or learning process, therefore, the following guidelines must be followed:

1. Footwear must be worn at all times. (**NO BARE FEET or SLIPPERS**).
2. Hats, hoods, bandanas, and sweatbands are not to be worn during the instructional day.
3. Do not wear cleats in the building.
4. Skate boards and roller shoes are not allowed on school property.
5. No underwear can be exposed, including bra straps.
6. No open-backs tops or dresses such as halter tops.
7. Skirts, shorts and dresses must be an acceptable length (just below fist level when arms are straight).
8. Clothing such as shorts, pants or skirts are not permitted to be worn lower than the hip-line.
9. Excessively tight shorts, pants, and skirts are unacceptable.
10. No midriff exposure, no exposed cleavage, no tube tops.
11. Sundresses and tops with spaghetti straps are acceptable as long as cleavage and the back are covered.
12. No tank tops of any kind are permitted to be worn by boys.
13. Leggings may be worn if the top is an acceptable length, (just below fist level when arms are straight) and conforms to the other elements of the dress code.
14. Low riding pants, shorts, or shirts that expose undergarments or anatomy are unacceptable.
15. Revealing, see-through clothing that excessively exposes anatomy is not permitted.
16. Clothing with inappropriate pictures, liquor advertisements, sexually suggestive messages, tobacco or gang affiliation, slogans, which contain offensive or obscene symbols or signs, slogans depicting violence or degrading any race, color, creed, religion, sex, ancestry, national origin, social or economic status, or sexual orientation or drug related messages are not permitted.
17. No trousers or slacks with studs or gaudy accessories. Also, no wrist, ankle, neckbands with spikes, chains, cleats, or other articles, which could cause damage to other students or property.

18. Outdoor jackets or coats are not to be worn except when entering or leaving the building, or when there is a defect in the heating system.
19. Sunglasses – non-prescription sunglasses, glazed and tinted glasses are not to be worn, except as prescribed by the student's doctor.

Please see the examples below of clothing that is not appropriate for school.

What Not To Wear



Any articles that are deemed by the Administration as distracting or disruptive to the educational process will not be permitted.

Students who violate the policy will receive one after school detention, with increasing penalties for subsequent offenses. Students will be sent to the Athletic Office and asked to change into more appropriate dress. Parents should understand that they might be asked to bring a change of clothing to school for students who are in violation of this school policy. The school administration reserves the right to make a final decision regarding appropriate dress in school and at school-sponsored events. If parents cannot be reached to bring appropriate clothing to the school, the student will be placed in the In-school Suspension Room until such time as appropriate attire can be provided. The school administration reserves the right to make a final decision regarding appropriate dress in school and at school-sponsored events.

Electronic Devices

- Cell phones and all other electronic devices such as iPods, media players, etc., are prohibited during the instructional day (7:30 a.m.—2:30 p.m.).
- All electronic devices should remain in the students' backpack until dismissal. Students should use wall clocks and wristwatches, not cell phones, to look up the time.
- Cell phones and other devices will be confiscated from students using them during the school day. Parents must come in to pick up the phones after the confiscation period is over.
- Electronic Devices:
 - 1st offense: device is confiscated for one week/1 extended detention
 - 2nd offense: device is confiscated for 2 weeks/3 extended detentions
 - 3rd offense: device is confiscated for one month/5 extended detentions
 - 4th offense: device is confiscated until the end of the school year/5 extended detentions

IMPORTANT: Early Dismissal Procedures

Early dismissals are discouraged. However, the school will honor medical/dental appointments and extreme emergencies.

- To arrange for early dismissal, a parent must write a note to the Attendance Office specifying the date, time, and reason for the request. Students are responsible for bringing the note to the Attendance Office the morning of their early dismissal.

- **The Attendance Office will follow up by contacting the parent to verify the early dismissal.** If the parent cannot be reached to verify the early dismissal, the student could be refused permission to leave.
- The student will then be given a pass to come to the Attendance Office at the designated time of departure. It is the student's responsibility to come to Attendance at the appointed time.
- There may be times when a parent must make an appointment with the doctor during the current school day, but please make sure your child is aware that you will be calling for an appointment. It is the **student's responsibility** to then check with the Attendance Office (in between classes) to see if the parent has called with the dismissal time.
- Classes cannot be interrupted to request that a student come down to attendance.
- **THE PARENT MUST COME TO THE ATTENDANCE OFFICE TO MEET THE CHILD AND SIGN THE EARLY DISMISSAL BOOK.** Students will be allowed to leave with another parent if a note is presented to the administration and parental approval is confirmed.

Please note that in accordance with the federal No Child Left Behind Act, 100% of our teachers meet the definition of a Highly Qualified Teacher. By law, parents have the right to inquire about the qualifications and highly qualified status of their child's teacher.

Again, welcome to the 2009-2010 school year. We extend our best wishes to everyone for a successful school year.

Sincerely,

Michael P. Hughes
Principal

Enclosure: Administrative Contact List
Alpha Homeroom List – 2009-2010

Contacting an Administrator

Periodically parents ask, "Who do I talk to if an issue exists that affects my child?" My best advice is to begin with the teacher, coach, or advisor who is closest to the issue and can offer real-time advice. This can best be accomplished by calling the school (713-4199) and leaving a message, or perhaps contacting your child's counselor. This step should always be taken prior to using other options. If however, you believe that a satisfactory response has not been rendered, the following is a list of administrators and the areas that they supervise:

<i>NAME</i>	<i>RESPONSIBILITY</i>	<i>TELEPHONE EXTENSION</i>	<i>E-MAIL ADDRESS</i>
Shane Berry	Fine Arts Supervisor	6537	sberry@nhvweb.net
Robert Farrell	Practical Arts Supervisor	6561	rfarrell@nhvweb.net
Caitlin Ryan	English Supervisor	6435	cryan@nhvweb.net
Susan Rader	World Language Supervisor	6436	srader@nhvweb.net
Patricia Raleigh	Guidance Supervisor	6408	praleigh@nhvweb.net
Carol Skidmore	Mathematics Supervisor	6433	cskidmore@nhvweb.net
David Lockart	Music Supervisor	6441	dlockart@nhvweb.net
Michael Gleason	Dean of Students/Physical Education & Health Supervisor	6421	mgleason@nhvweb.net
Louis Mazzella	Science Supervisor	6431	lmazzella@nhvweb.net
Chris Schumann	Social Studies Supervisor	6430	cschumann@nhvweb.net
Barbara Venezia	Special Education Supervisor	6418	bvenezia@nhvweb.net
Tara Kraatz	Director of Student Activities	6367	tkraatz@nhvweb.net
Virginia Konefal/ Martha Hickson	Media Specialists	6416 6414	vkonefal@nhvweb.net mhickson@nhvweb.net
Catherine Fumosa or Gloria Caputo-Korman	Nurses	6391 6391	cfumosa@nhvweb.net gcaputokorman@nhvweb.net
William Jehl or Karen Korbul	Athletic Trainers	6142 4309	wjehl@nhvweb.net or kkorbul@nhvweb.net
Carol Crawford-Jones	Gifted & Talented Coordinator	6468	ccrawford-jones@nhvweb.net
John Deutsch	Director of Athletics	6401	jdeutsch@nhvweb.net
Michael Hughes	Principal	6350	mhughes@nhvweb.net
Irene Dolan	Assistant Principal for Operations	6354	idolan@nhvweb.net
John Hahola	Assistant Principal for Instruction	6351	jhahola@nhvweb.net

If you have exhausted these steps without satisfaction, please feel free to call me at Ext. 6350 or e-mail me:
mhughes@nhvweb.net

Revised 08/09

ALPHA HOMEROOM LIST

Grade 11

Last Name	Homeroom
Abbott – Bednar	S150
Bell – Buchanan	S151
Buess – Ceres	S152
Chao – Delia	S153
Demicco – Falcucci	S154
Fania – Gamanho	S155
Ganihanova – Hachey	241
Hadley – Jacques	250
Jakaj – Kolln	251
Koprowski – Lihan	252
Linzer – Mastrogiacomo	253
Mathues – Moore	254
Morris – Ostrowski	245
Pappas – Porretta	243
Porter – Resua	242
Riccardi – Savarese	S156
Savicki – Snider	026
Snow – Sun	026
Tabaka – Ward	028
Ware – Zuccarelli	028

ALPHA HOMEROOM LIST

Grade 12

Last Name	Homeroom
Adamcik – Bertocci	218
Bobal – Castellanos	219
Cesta – Cusumano	220
D’Alessandro – Duh	221
Dwarnick – Frazier	222
Frederickson – Gubernat	224
Haapaoja – Izzo	225
Jackson – Korbul	238
Kowalchuk – Liu	228
Loftus – Matarazzo	229
Matheus – Murray	230
Nagy – Petryna	231
Phillips – Ronan	232
Roseberry – Sherrerd	234
Shirey – Tejeda	235
Teres – Whalen	236
White – Zimmerman	237

ALPHA HOMEROOM LIST

Grade 9

Last Name	Homeroom
Adamcik – Bean	010
Bellofatto – Brown	012
Buehler – Cocchiola	014
Cole – Dixon	015
Donahue – Fiorelli	016
Fitzgerald – Georgeles	017
Ghali – Havay	018
Hayes – Izlar	RW Lab
Jablonski – Korbul	108
Kortina – Liu	110
LoCascio – McCoy	111
McGinnis – Muldowney	112
Murphy – Peer	113
Pepe – Query	207
Quezada – Russell	208
Russillo – Shanoski	209
Shirey – Talis	210
Teklinski – Walter	214
Wang – Witkowski	216
Witte – Zaugg	217

ALPHA HOMEROOM LIST

Grade 10

Last Name	Homeroom
Adam - Blalock	122
Booth - Burgess	120
Burns – Coleman	126
Collins - Dickson	117
Dincuff - Fogel	132
Folsom - Gray	200
Greco - Iannelli	201
Ike - Kish	204
Knaub - Lee	205
Lemise - Many	211
Mardini - Mercurio	240
Meyer – O'Hara	129
O'Reilly - Piwinski	Café A-2
Platt - Rivera	Café B-3
Roberts - Schwarzmann	212
Scott - Skillman	227
Smith - Sweeney	Café A-1
Swyzen - Vrancken	Café B
Wall - Zhang	Café B-2